

Historical Mapping Legends

Ordnance Survey County Series and Ordnance Survey Plan 1:2,500



Ordnance Survey Plan, Additional SIMs and Supply of Unpublished Survey Information 1:2,500 and 1:1,250



Large-Scale National Grid Data 1:2,500 and 1:1,250

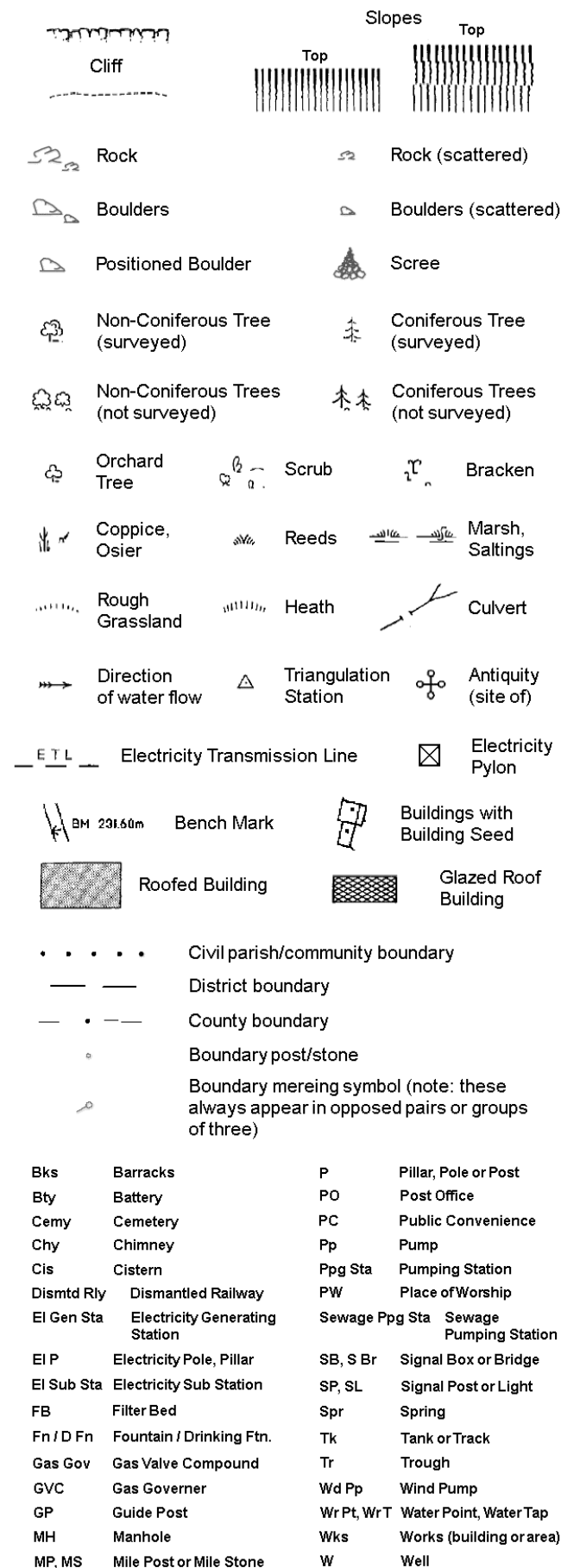

your earth our world

Historical Mapping & Photography included:

| Mapping Type | Scale | Date | Pg |
|--------------------------------|---------|-------------|----|
| Staffordshire | 1:2,500 | 1880 | 2 |
| Staffordshire | 1:2,500 | 1901 | 3 |
| Staffordshire | 1:2,500 | 1924 | 4 |
| Staffordshire | 1:2,500 | 1937 | 5 |
| Ordnance Survey Plan | 1:2,500 | 1957 - 1970 | 6 |
| Additional SIMs | 1:2,500 | 1957 - 1978 | 7 |
| Additional SIMs | 1:2,500 | 1978 - 1984 | 8 |
| Additional SIMs | 1:2,500 | 1987 - 1989 | 9 |
| Large-Scale National Grid Data | 1:2,500 | 1994 | 10 |

Historical Map - Segment A10

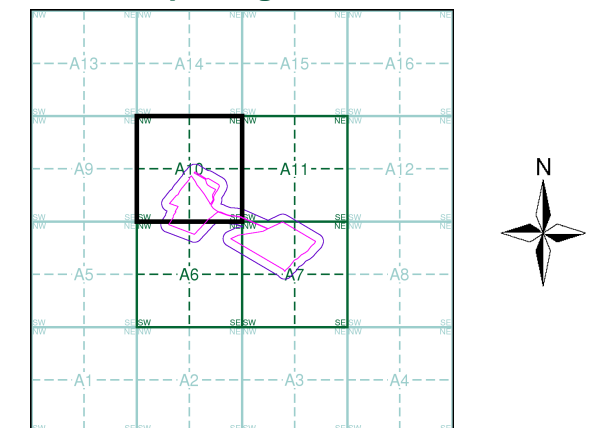

Order Details

Order Number: 52105505_1_1
Customer Ref: ST13776
National Grid Reference: 397810, 338960
Slice: A
Site Area (Ha): 15.12
Search Buffer (m): 50

Site Details

16 Sandon Road, Cresswell, STOKE-ON-TRENT, ST11 9RB



Tel: 0844 844 9952
Fax: 0844 844 9951
Web: www.envirocheck.co.uk



your earth our world

Staffordshire

Published 1880

Source map scale - 1:2,500

The historical maps shown were reproduced from maps predominantly held at the scale adopted for England, Wales and Scotland in the 1840's. In 1854 the 1:2,500 scale was adopted for mapping urban areas and by 1896 it covered the whole of what were considered to be the cultivated parts of Great Britain. The published date given below is often some years later than the surveyed date. Before 1938, all OS maps were based on the Cassini Projection, with independent surveys of a single county or group of counties, giving rise to significant inaccuracies in outlying areas.

Map Name(s) and Date(s)

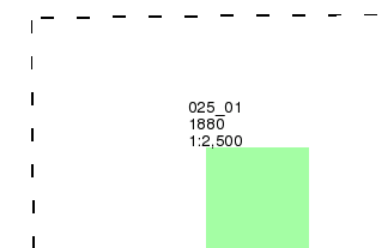

Historical Map - Segment A10

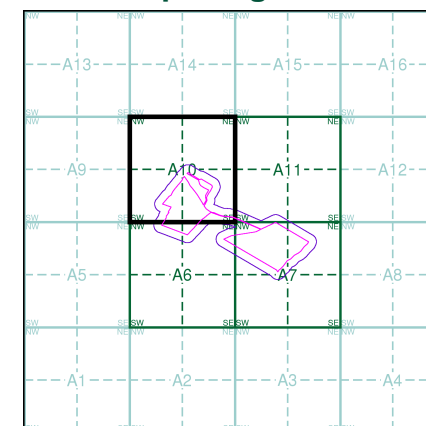

Order Details

Order Number: 52105505_1_1
Customer Ref: ST13776
National Grid Reference: 397810, 338960
Slice: A
Site Area (Ha): 15.12
Search Buffer (m): 50

Site Details

16 Sandon Road, Cresswell, STOKE-ON-TRENT, ST11 9RB



Tel: 0844 844 9952
Fax: 0844 844 9951
Web: www.envirocheck.co.uk

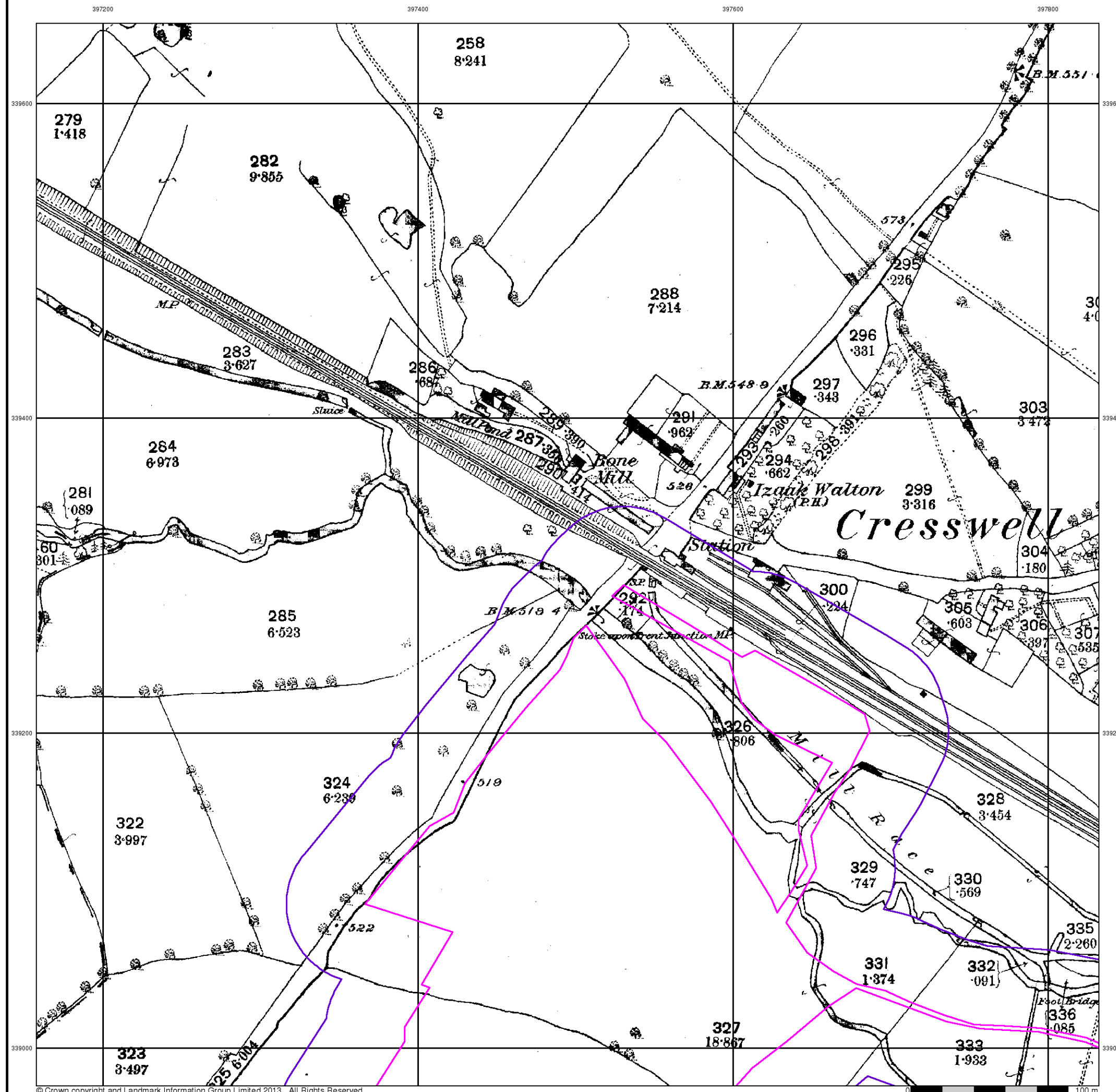



your earth our world

Staffordshire

Published 1901

Source map scale - 1:2,500

The historical maps shown were reproduced from maps predominantly held at the scale adopted for England, Wales and Scotland in the 1840's. In 1854 the 1:2,500 scale was adopted for mapping urban areas and by 1896 it covered the whole of what were considered to be the cultivated parts of Great Britain. The published date given below is often some years later than the surveyed date. Before 1938, all OS maps were based on the Cassini Projection, with independent surveys of a single county or group of counties, giving rise to significant inaccuracies in outlying areas.

Map Name(s) and Date(s)

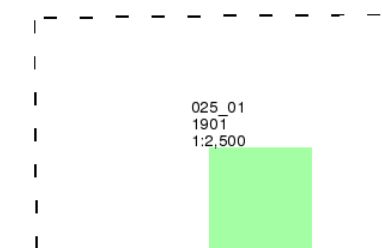

Historical Map - Segment A10

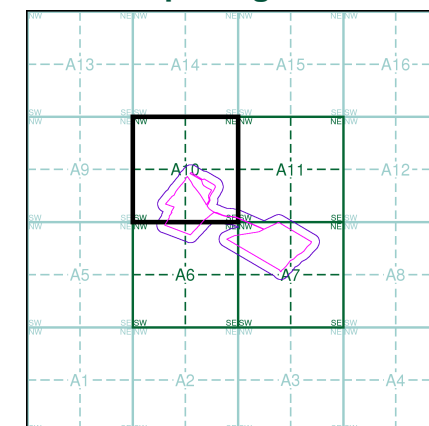

Order Details

Order Number: 52105505_1_1
Customer Ref: ST13776
National Grid Reference: 397810, 338960
Slice: A
Site Area (Ha): 15.12
Search Buffer (m): 50

Site Details

16 Sandon Road, Cresswell, STOKE-ON-TRENT, ST11 9RB



Tel: 0844 844 9952
Fax: 0844 844 9951
Web: www.envirocheck.co.uk

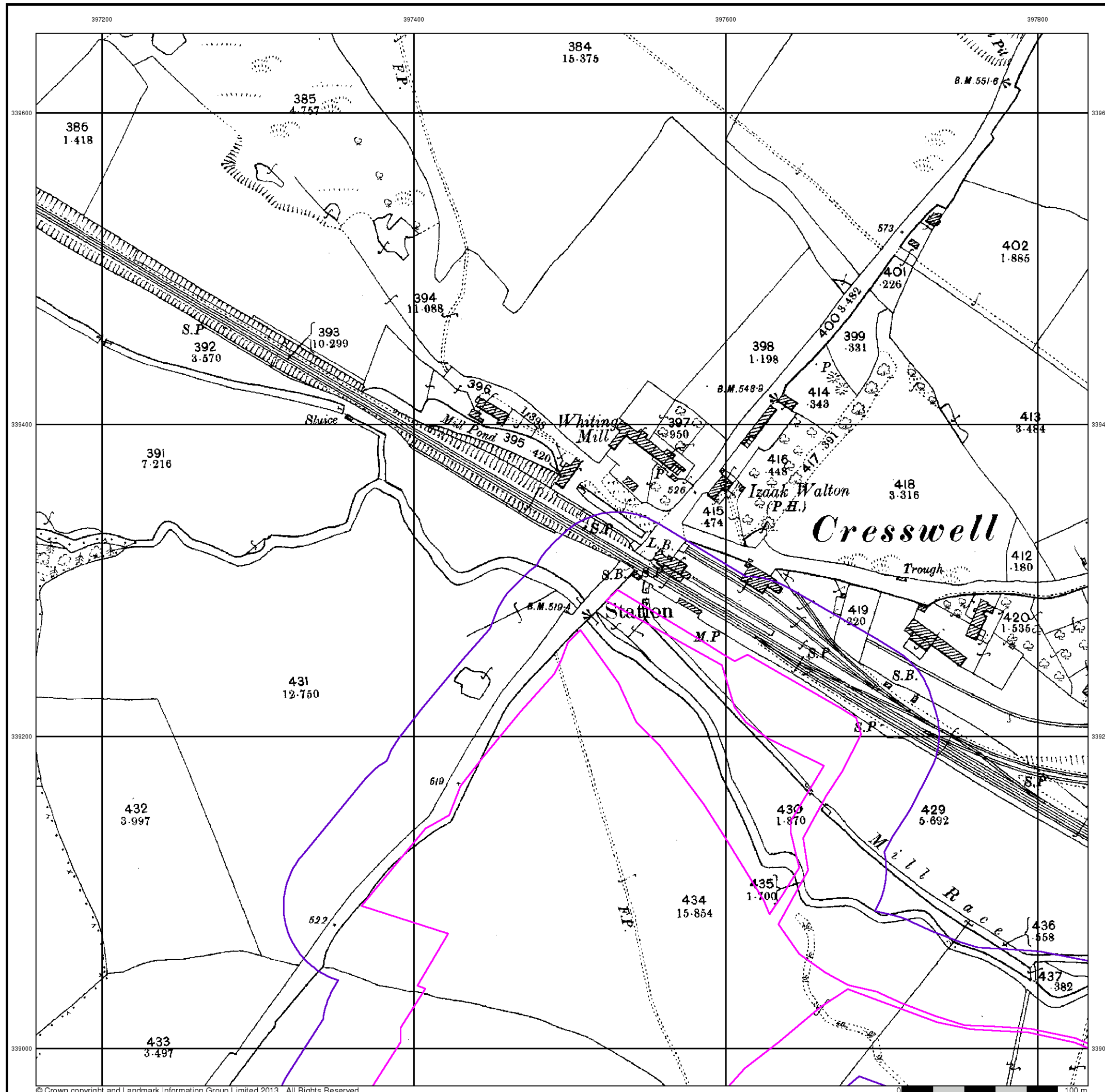

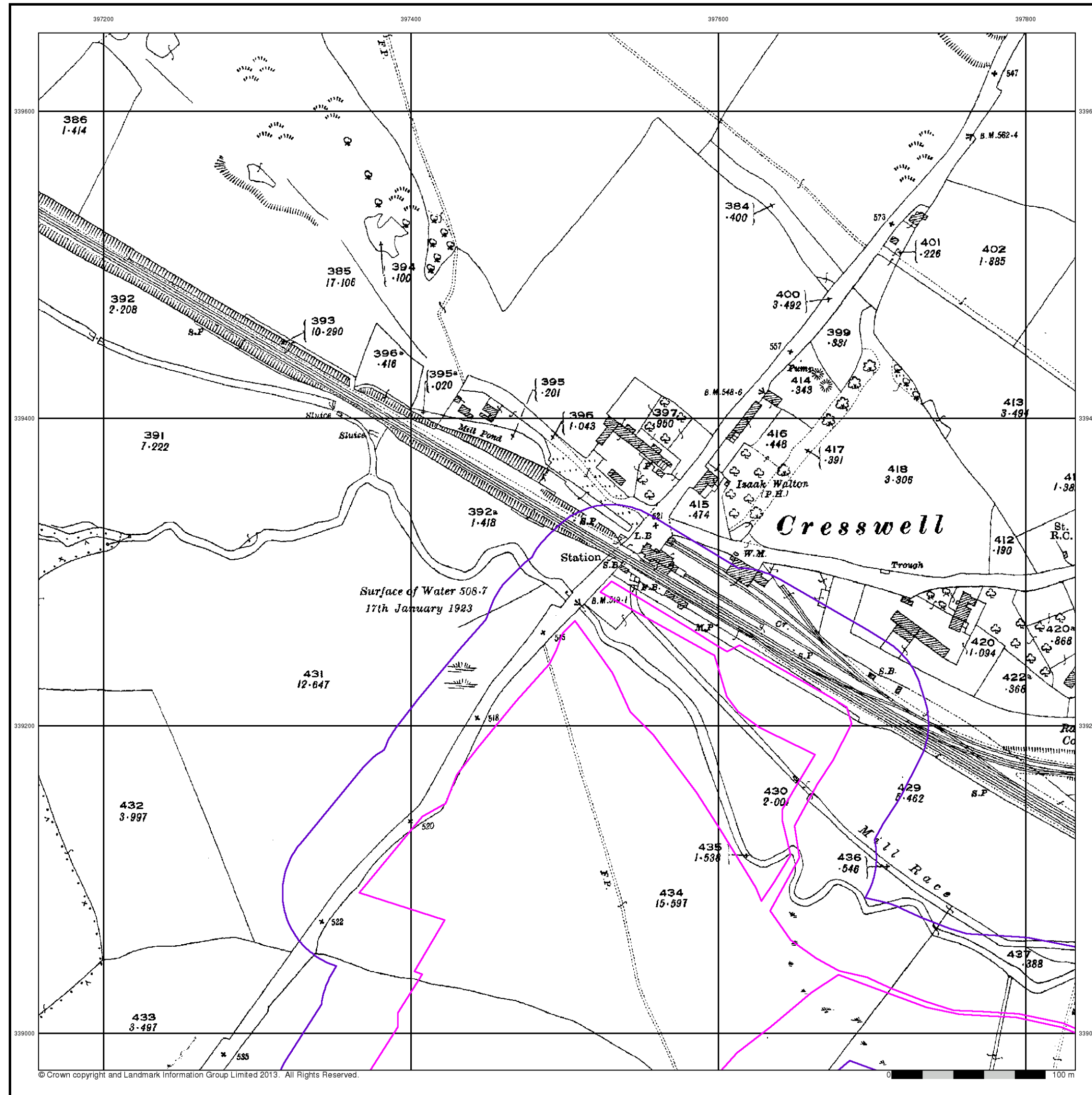

your earth our world

Staffordshire

Published 1924

Source map scale - 1:2,500

The historical maps shown were reproduced from maps predominantly held at the scale adopted for England, Wales and Scotland in the 1840's. In 1854 the 1:2,500 scale was adopted for mapping urban areas and by 1896 it covered the whole of what were considered to be the cultivated parts of Great Britain. The published date given below is often some years later than the surveyed date. Before 1938, all OS maps were based on the Cassini Projection, with independent surveys of a single county or group of counties, giving rise to significant inaccuracies in outlying areas.

Map Name(s) and Date(s)

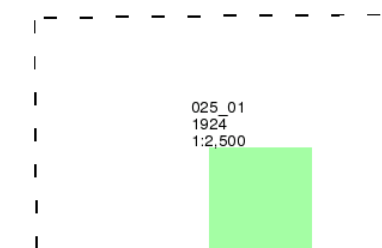

Historical Map - Segment A10

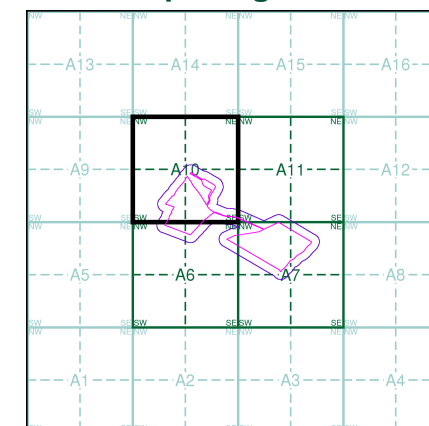

Order Details

Order Number: 52105505_1_1
Customer Ref: ST13776
National Grid Reference: 397810, 338960
Slice: A
Site Area (Ha): 15.12
Search Buffer (m): 50

Site Details

16 Sandon Road, Cresswell, STOKE-ON-TRENT, ST11 9RB



Tel: 0844 844 9952
Fax: 0844 844 9951
Web: www.envirocheck.co.uk

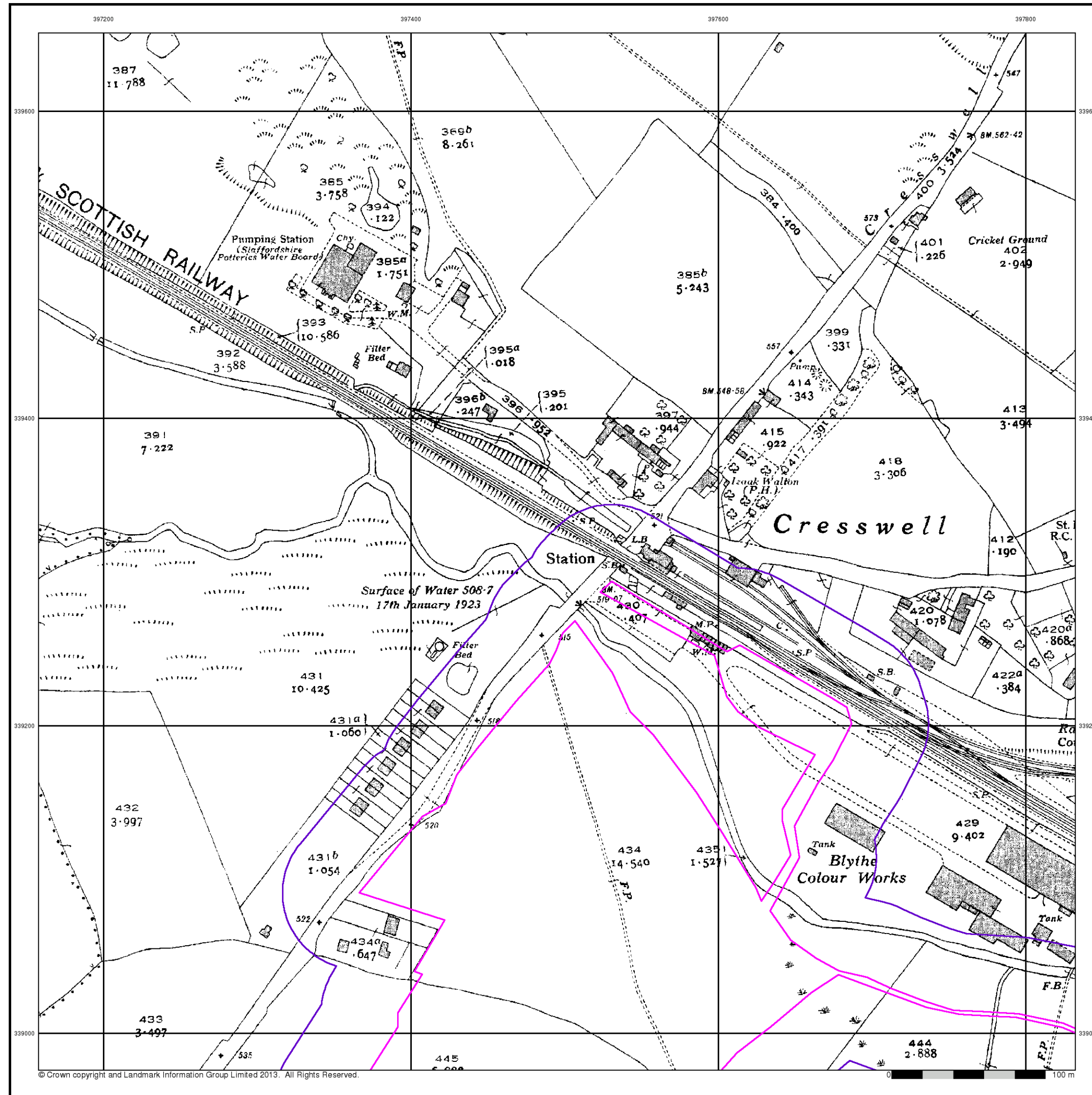

your earth our world

Staffordshire

Published 1937

Source map scale - 1:2,500

The historical maps shown were reproduced from maps predominantly held at the scale adopted for England, Wales and Scotland in the 1840's. In 1854 the 1:2,500 scale was adopted for mapping urban areas and by 1896 it covered the whole of what were considered to be the cultivated parts of Great Britain. The published date given below is often some years later than the surveyed date. Before 1938, all OS maps were based on the Cassini Projection, with independent surveys of a single county or group of counties, giving rise to significant inaccuracies in outlying areas.

Map Name(s) and Date(s)

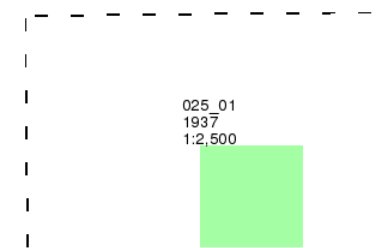

Historical Map - Segment A10

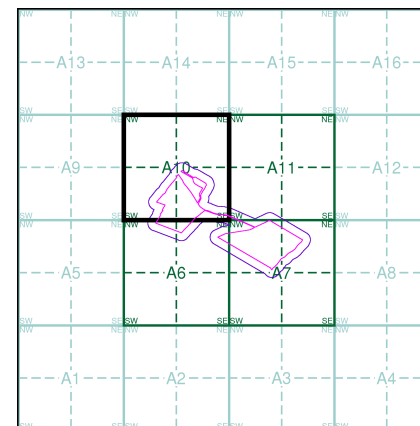

Order Details

Order Number: 52105505_1_1
Customer Ref: ST13776
National Grid Reference: 397810, 338960
Slice: A
Site Area (Ha): 15.12
Search Buffer (m): 50

Site Details

16 Sandon Road, Cresswell, STOKE-ON-TRENT, ST11 9RB



Tel: 0844 844 9952
Fax: 0844 844 9951
Web: www.envirocheck.co.uk

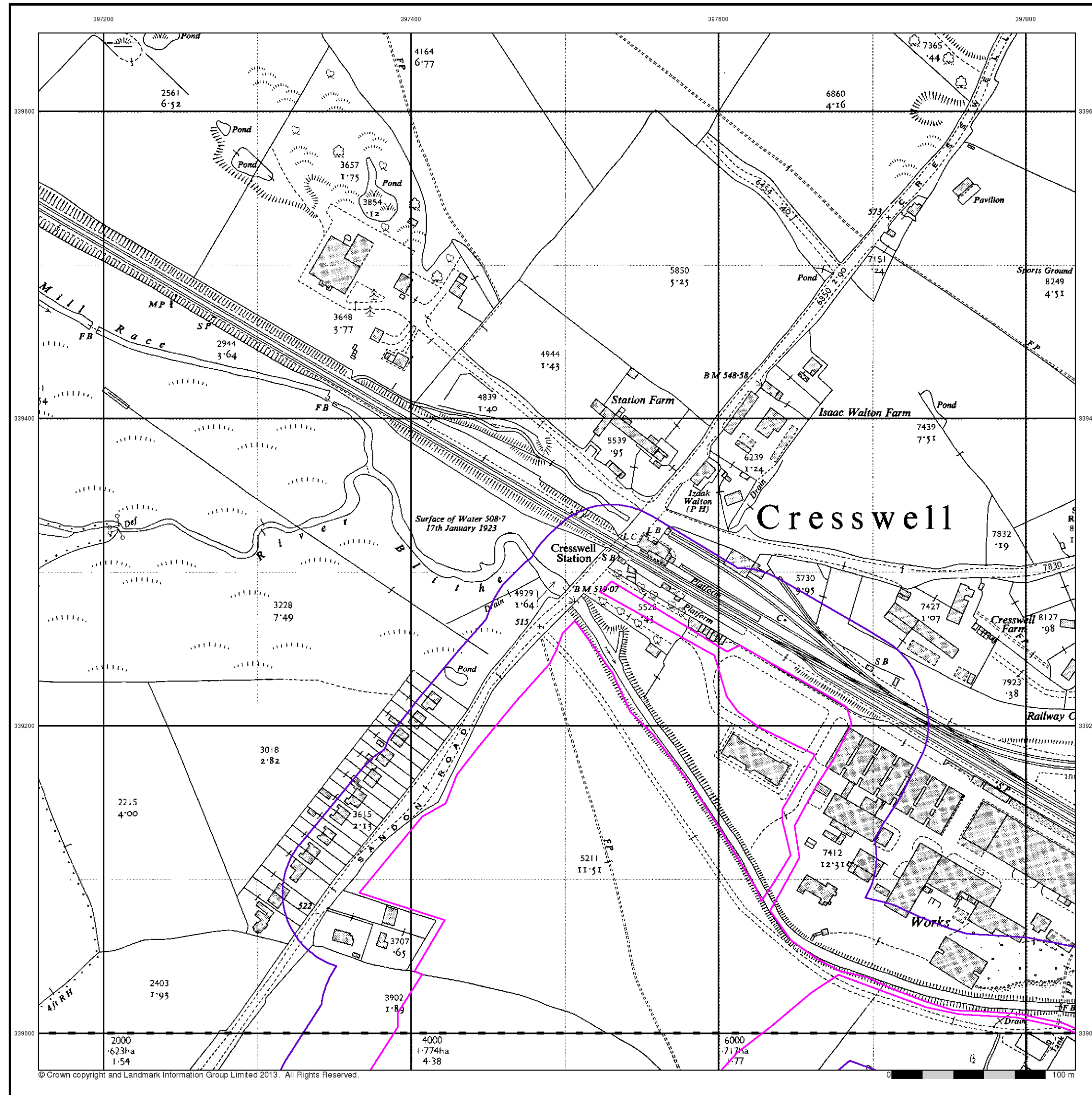

your earth our world

Ordnance Survey Plan

Published 1957 - 1970

Source map scale - 1:2,500

The historical maps shown were reproduced from maps predominantly held at the scale adopted for England, Wales and Scotland in the 1840's. In 1854 the 1:2,500 scale was adopted for mapping urban areas and by 1896 it covered the whole of what were considered to be the cultivated parts of Great Britain. The published date given below is often some years later than the surveyed date. Before 1938, all OS maps were based on the Cassini Projection, with independent surveys of a single county or group of counties, giving rise to significant inaccuracies in outlying areas.

Map Name(s) and Date(s)

| |
|---------|
| SJ9739 |
| 1957 |
| 1:2,500 |
| SJ9738 |
| 1970 |
| 1:2,500 |

Historical Map - Segment A10

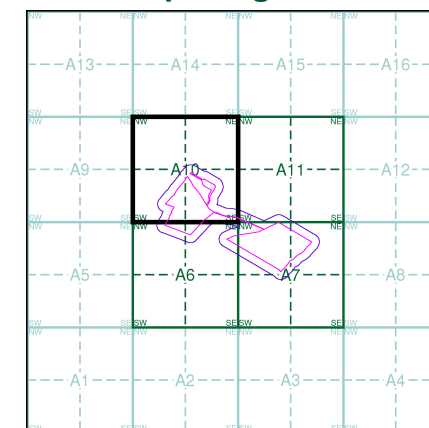

Order Details

Order Number: 52105505_1_1
Customer Ref: ST13776
National Grid Reference: 397810, 338960
Slice: A
Site Area (Ha): 15.12
Search Buffer (m): 50

Site Details

16 Sandon Road, Cresswell, STOKE-ON-TRENT, ST11 9RB



Tel: 0844 844 9952
Fax: 0844 844 9951
Web: www.envirocheck.co.uk

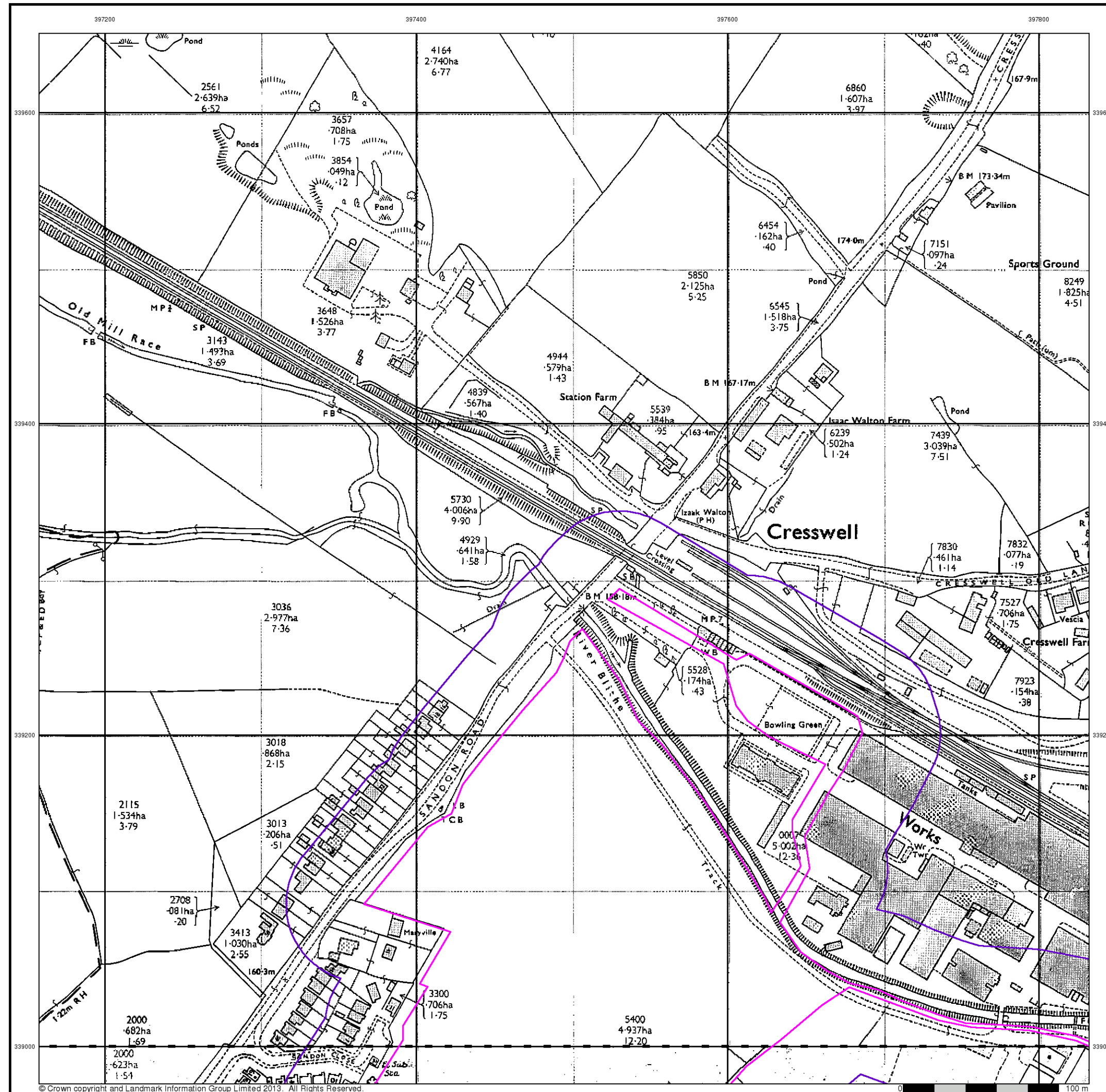

your earth our world

Additional SIMs

Published 1957 - 1978

Source map scale - 1:2,500

The SIM cards (Ordnance Survey's 'Survey of Information on Microfilm') are further, minor editions of mapping which were produced and published in between the main editions as an area was updated. They date from 1947 to 1994, and contain detailed information on buildings, roads and land-use. These maps were produced at both 1:2,500 and 1:1,250 scales.

Map Name(s) and Date(s)

| | | |
|--------|------|---------|
| SJ9739 | 1957 | 1:2,500 |
| SJ9738 | 1978 | 1:2,500 |

Historical Map - Segment A10

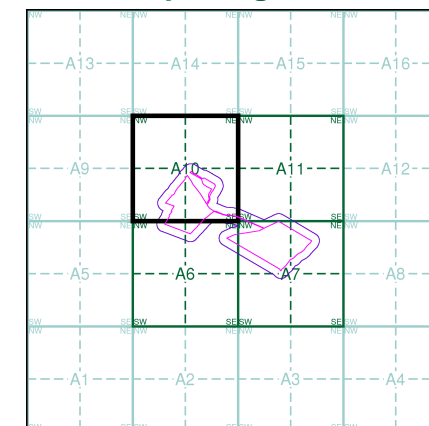

Order Details

Order Number: 52105505_1_1
Customer Ref: ST13776
National Grid Reference: 397810, 338960
Slice: A
Site Area (Ha): 15.12
Search Buffer (m): 50

Site Details

16 Sandon Road, Cresswell, STOKE-ON-TRENT, ST11 9RB



Tel: 0844 844 9952
Fax: 0844 844 9951
Web: www.envirocheck.co.uk

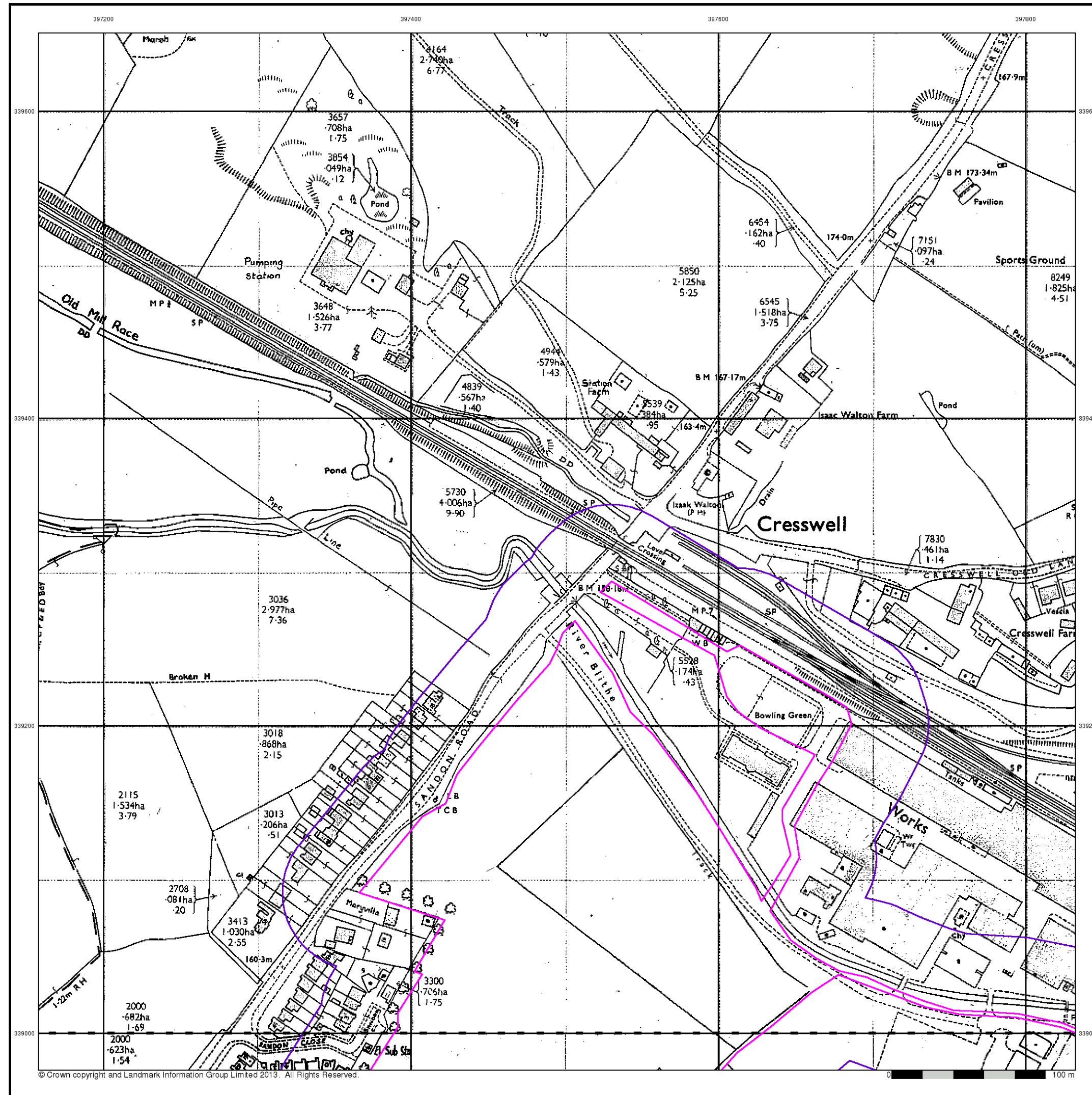

your earth our world

Additional SIMs

Published 1978 - 1984

Source map scale - 1:2,500

The SIM cards (Ordnance Survey's 'Survey of Information on Microfilm') are further, minor editions of mapping which were produced and published in between the main editions as an area was updated. They date from 1947 to 1994, and contain detailed information on buildings, roads and land-use. These maps were produced at both 1:2,500 and 1:1,250 scales.

Map Name(s) and Date(s)

| | | |
|--------|------|---------|
| SJ9739 | 1978 | 1:2,500 |
| SJ9738 | 1984 | 1:2,500 |

Historical Map - Segment A10

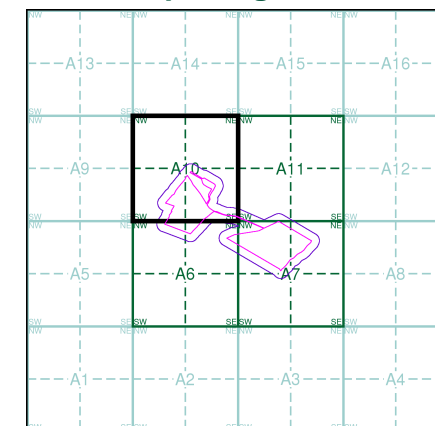

Order Details

Order Number: 52105505_1_1
Customer Ref: ST13776
National Grid Reference: 397810, 338960
Slice: A
Site Area (Ha): 15.12
Search Buffer (m): 50

Site Details

16 Sandon Road, Cresswell, STOKE-ON-TRENT, ST11 9RB



Tel: 0844 844 9952
Fax: 0844 844 9951
Web: www.envirocheck.co.uk

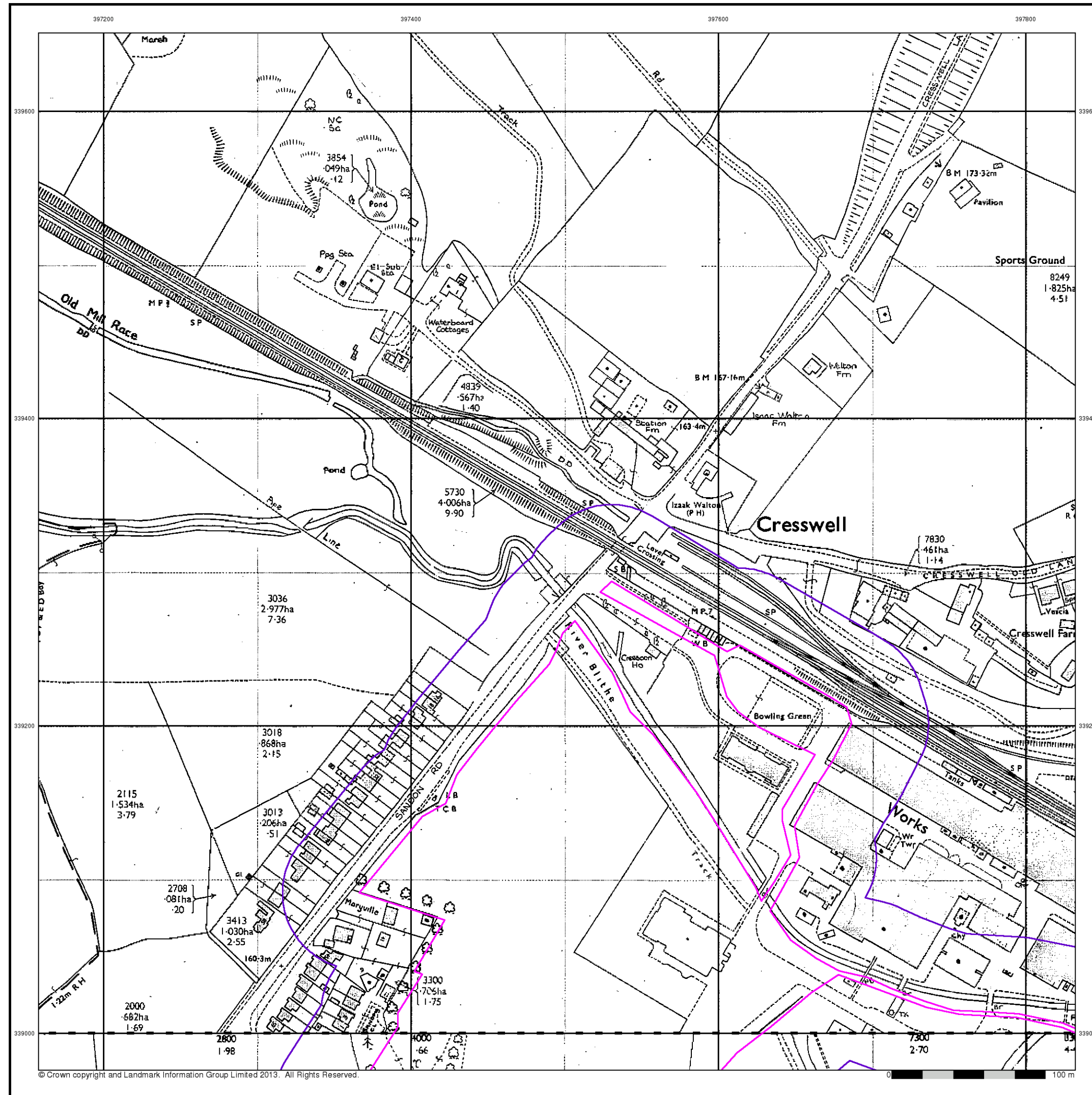

your earth our world

Additional SIMs

Published 1987 - 1989

Source map scale - 1:2,500

The SIM cards (Ordnance Survey's 'Survey of Information on Microfilm') are further, minor editions of mapping which were produced and published in between the main editions as an area was updated. They date from 1947 to 1994, and contain detailed information on buildings, roads and land-use. These maps were produced at both 1:2,500 and 1:1,250 scales.

Map Name(s) and Date(s)

| | | |
|--------|------|---------|
| SJ9739 | 1987 | 1:2,500 |
| SJ9738 | 1989 | 1:2,500 |

Historical Map - Segment A10

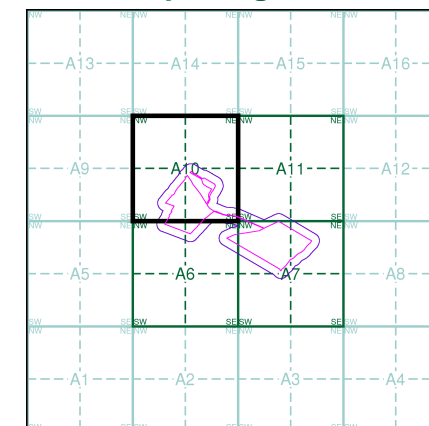

Order Details

Order Number: 52105505_1_1
Customer Ref: ST13776
National Grid Reference: 397810, 338960
Slice: A
Site Area (Ha): 15.12
Search Buffer (m): 50

Site Details

16 Sandon Road, Cresswell, STOKE-ON-TRENT, ST11 9RB



Tel: 0844 844 9952
Fax: 0844 844 9951
Web: www.envirocheck.co.uk

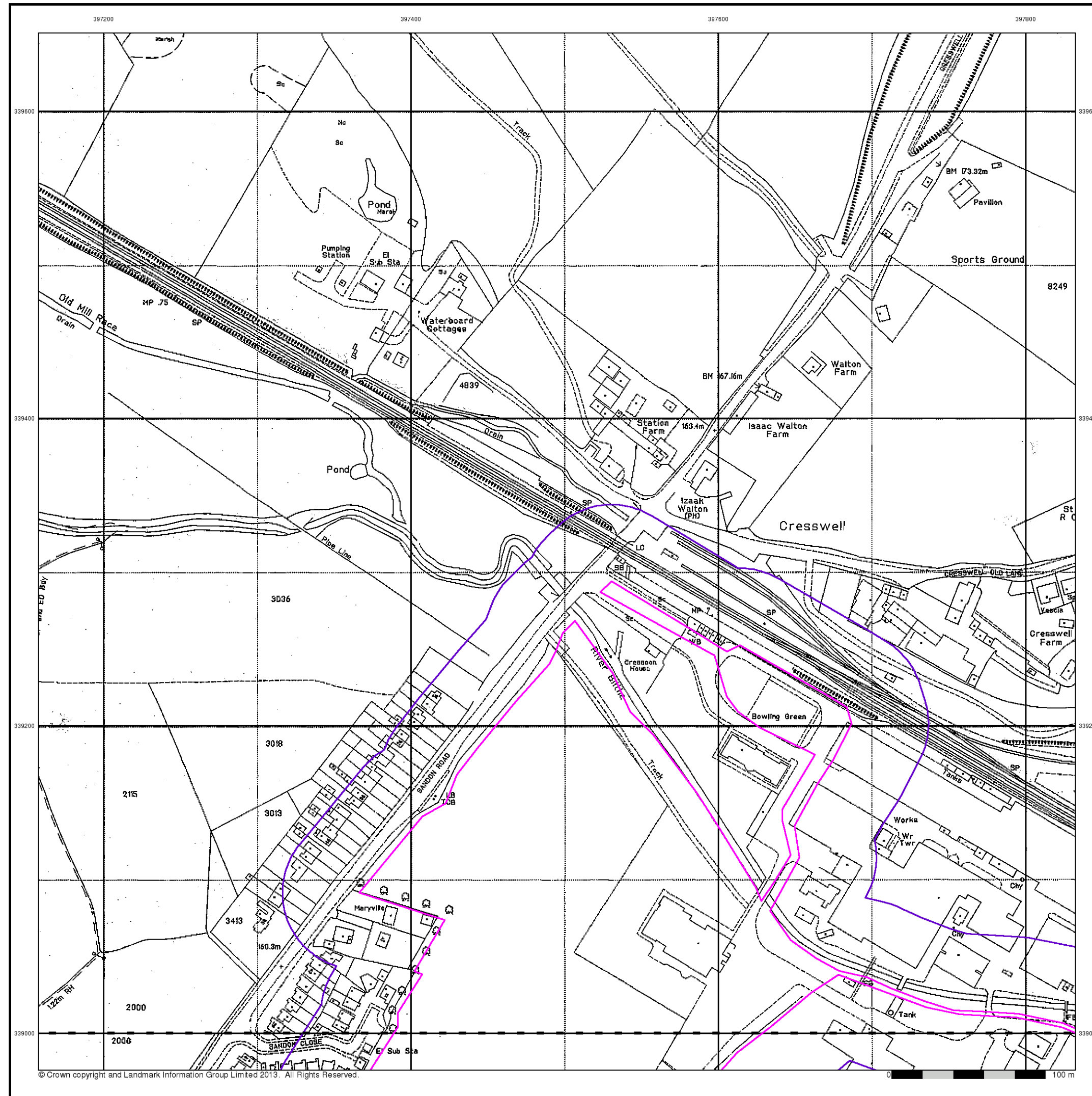

your earth our world

Large-Scale National Grid Data

Published 1994

Source map scale - 1:2,500

'Large Scale National Grid Data' superseded SIM cards (Ordnance Survey's 'Survey of Information on Microfilm') in 1992, and continued to be produced until 1999. These maps were the fore-runners of digital mapping and so provide detailed information on houses and roads, but tend to show less topographic features such as vegetation. These maps were produced at both 1:2,500 and 1:1,250 scales.

Map Name(s) and Date(s)

| | | |
|--------|------|---------|
| SJ9739 | 1994 | 1:2,500 |
| SJ9738 | 1994 | 1:2,500 |

Historical Map - Segment A10

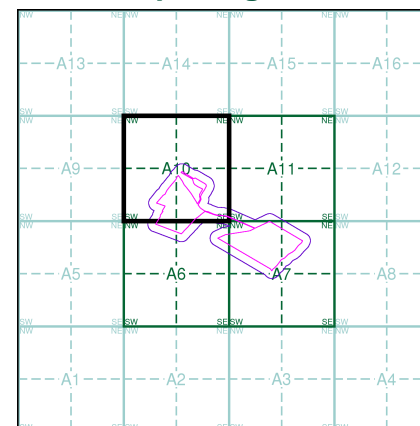

Order Details

Order Number: 52105505_1_1
Customer Ref: ST13776
National Grid Reference: 397810, 338960
Slice: A
Site Area (Ha): 15.12
Search Buffer (m): 50

Site Details

16 Sandon Road, Cresswell, STOKE-ON-TRENT, ST11 9RB



Tel: 0844 844 9952
Fax: 0844 844 9951
Web: www.envirocheck.co.uk