

1. This drawing is copyright.
2. All dimensions to be checked on site before proceeding.
3. Contractor to check/adjust dimensions of new work to suit existing conditions. Do not assume existing structure or details are plumb, square or level.
4. Contractor must notify the architect of any discrepancies before proceeding.
5. All drawings to be read in conjunction with all other consultants drawings and specs.

key
 [hatched] land and buildings owned Moorlands Housing to be transferred to LMBHT
 [unhatched] land owned by Staffordshire Moorlands District Council

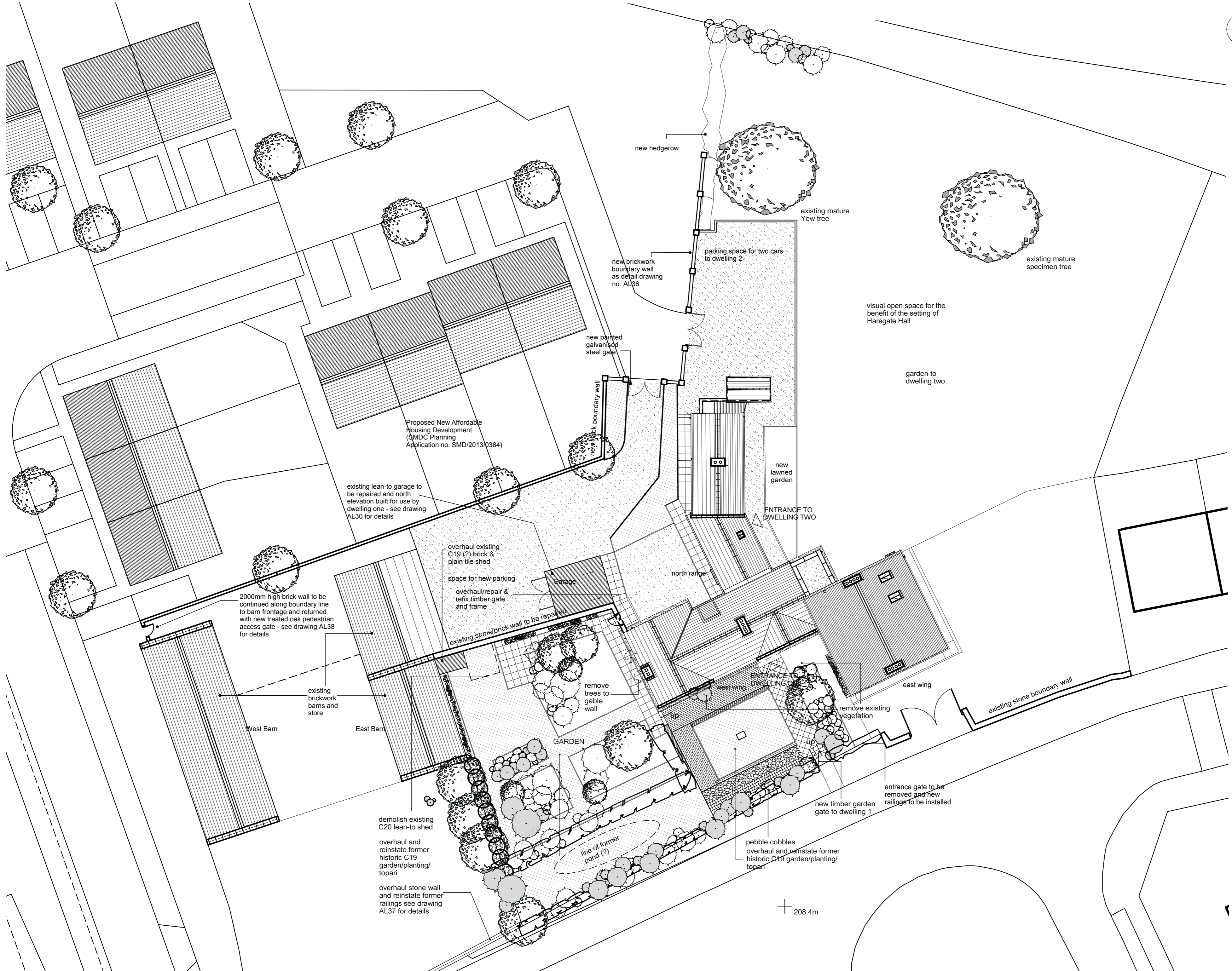

Rev	Date	Drawn	Description
A	29/11/13	LC	new parking introduced to rear of dwelling 2; boundary wall extended behind barn to outgaze.

ctd architects

Clerk Bank House
 Clerk Bank
 Staffordshire
 ST13 5HE

Tel: 01538 373477
 Fax: 01538 396503
 e: info@ctdarchitects.co.uk

architects | historic building advisors | project managers | landscapers & urban designers

Client	Rachel Trafford
Project	Haregate Hall, 17th Century House conservation repairs, reinstatement & conversion of Grade II Listed house
Title	site block plan : as proposed

Status: **PLANNING & LBC**

Scale:	1:200	A2	Size:	296	1345
Drawn:	LC	CHK	Date:	Nov 2013	
File path:	\\server\projects\2013\17th Century House\17th Century House.dwg				
Drawing Number:	AL28	Revision:	A		