

1. This drawing is copyright.
2. All dimensions to be checked on site before proceeding.
3. Contractor to check/adjust dimensions of new work to suit existing conditions. Do not assume existing structure or details are plumb, square or level.
4. Contractor must notify the architect of any discrepancies before proceeding.
5. All drawings to be read in conjunction with all other consultants drawings and specs.

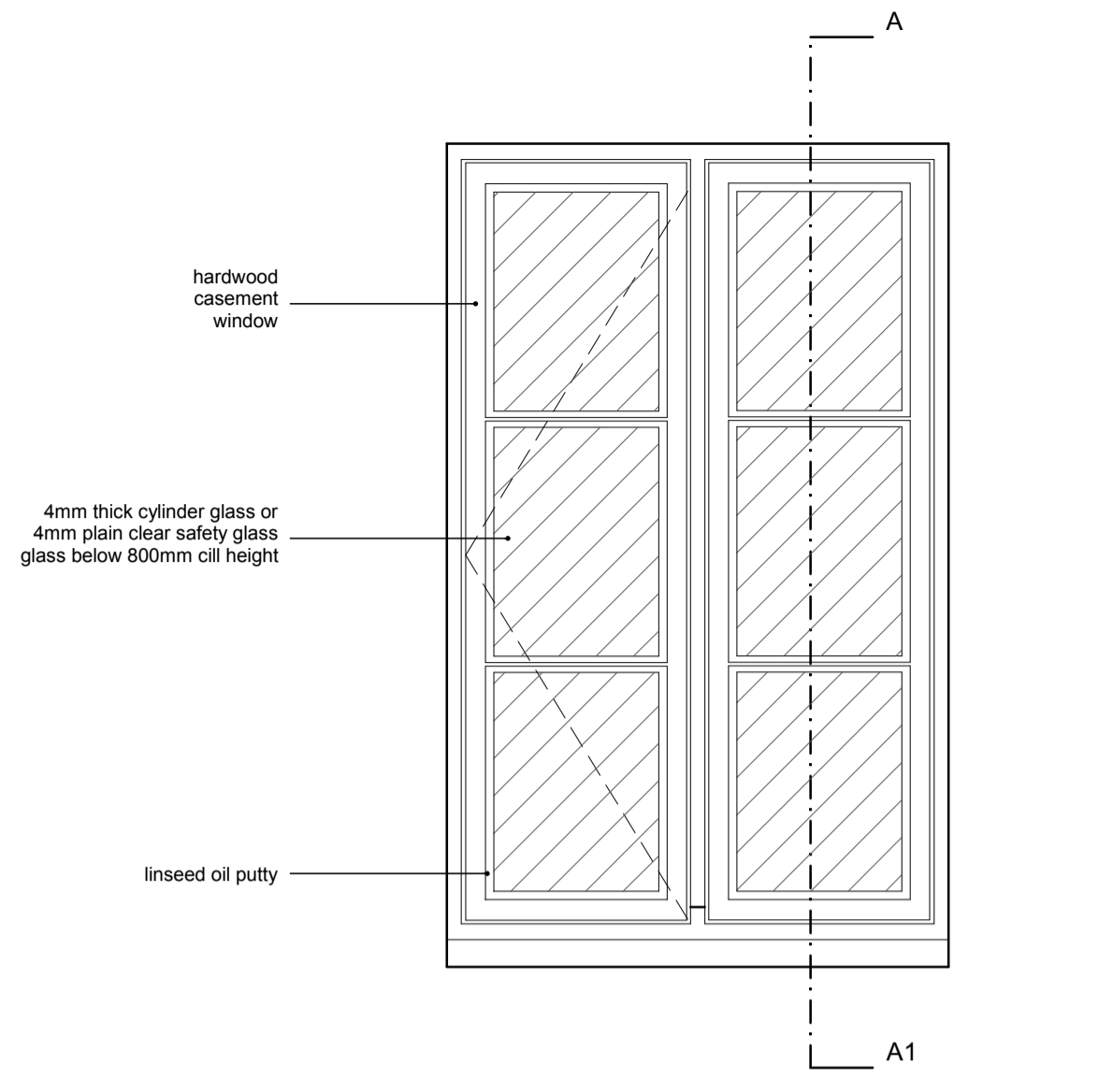

typical casement window elevation
scale 1:10

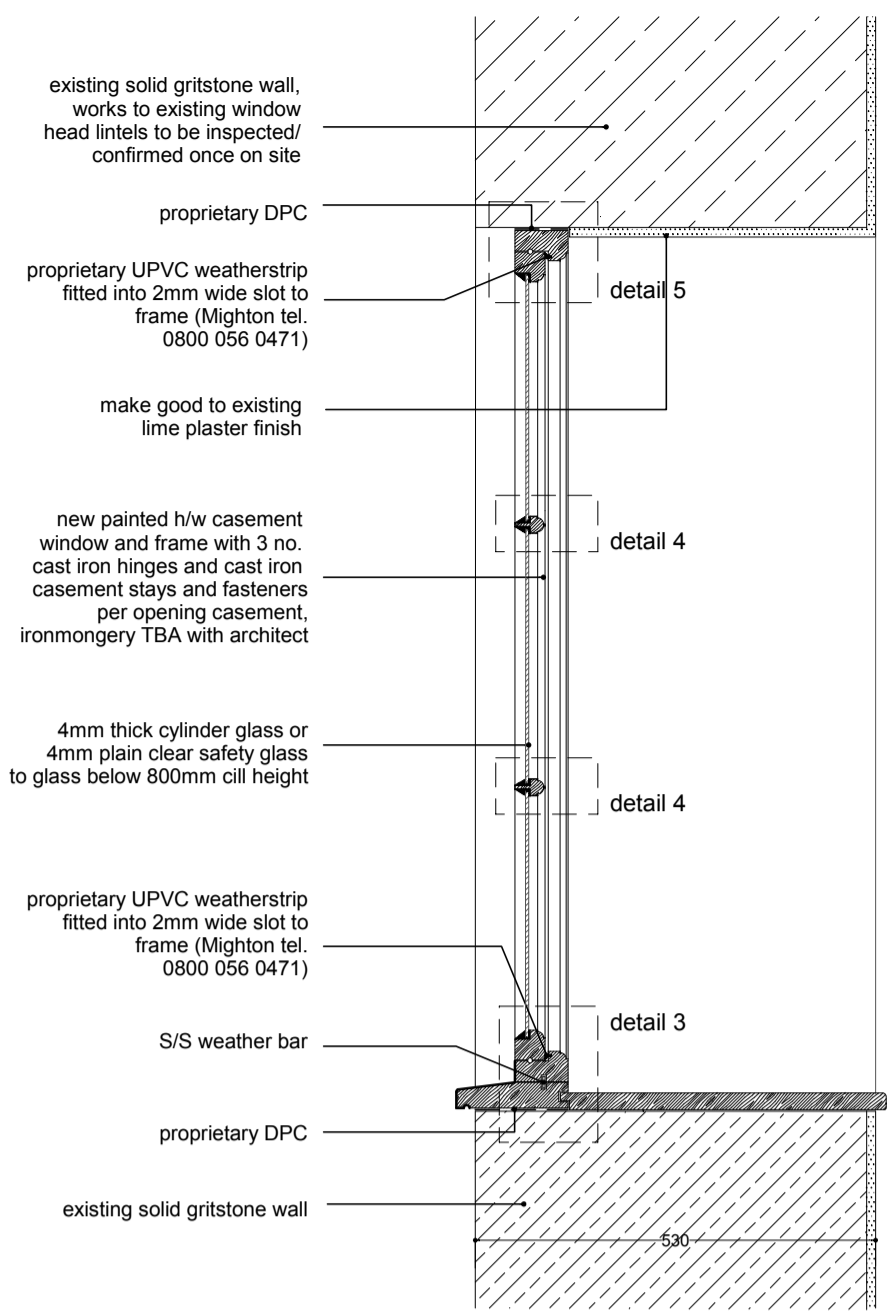

typical casement window section
scale 1:10

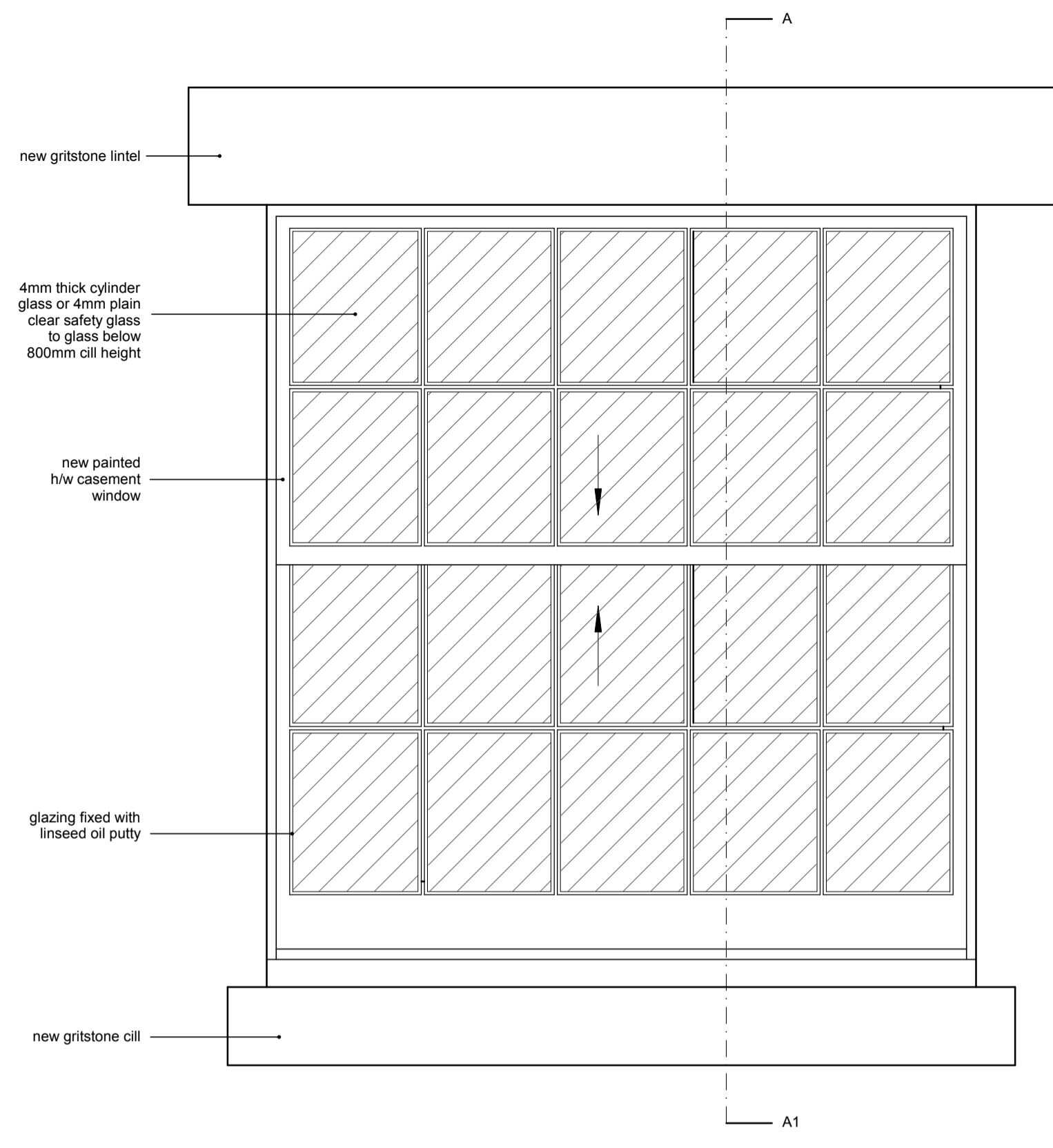

new double hung vertically sliding sash window to W3 elevation
scale 1:10

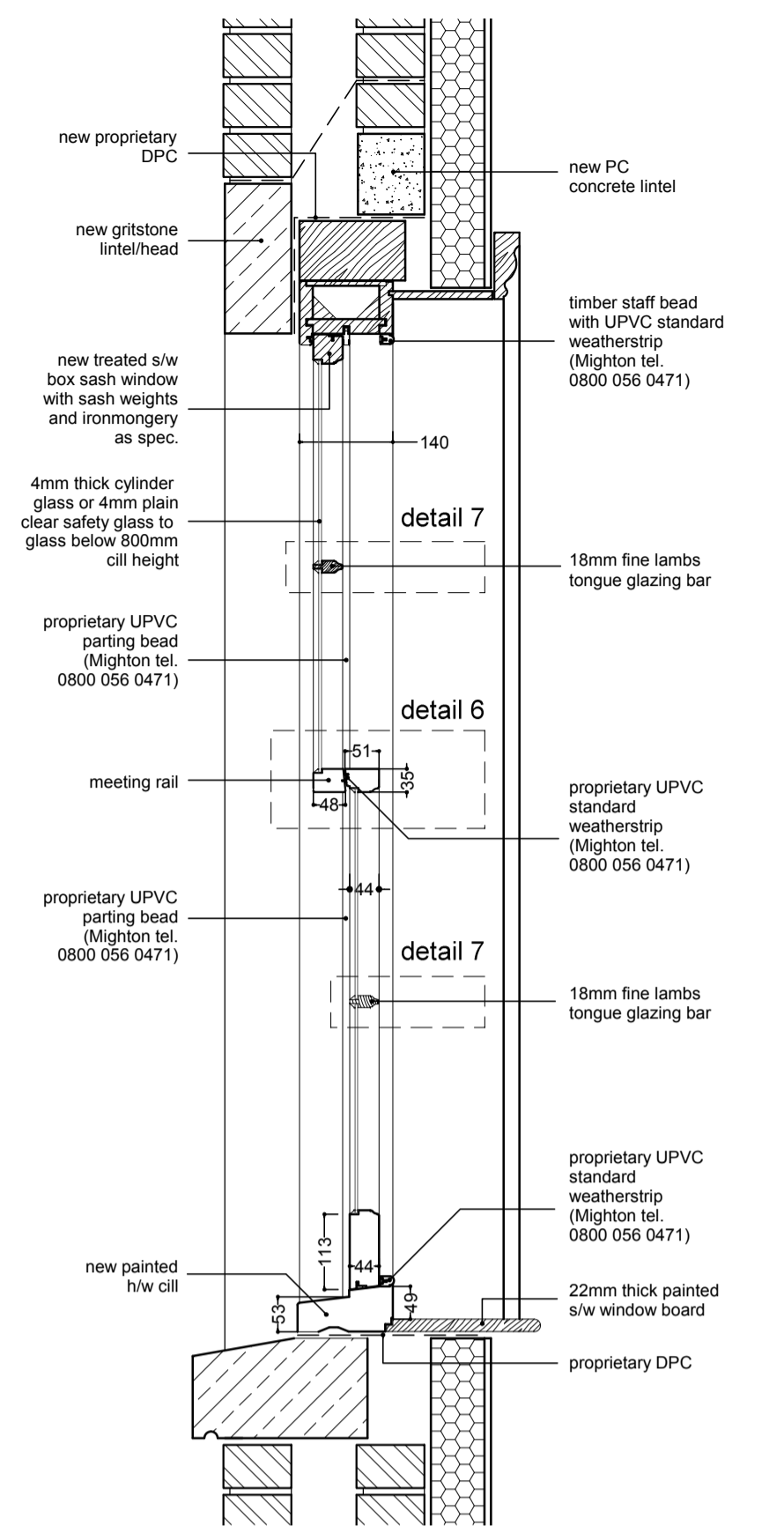

typical sash section
scale 1:10

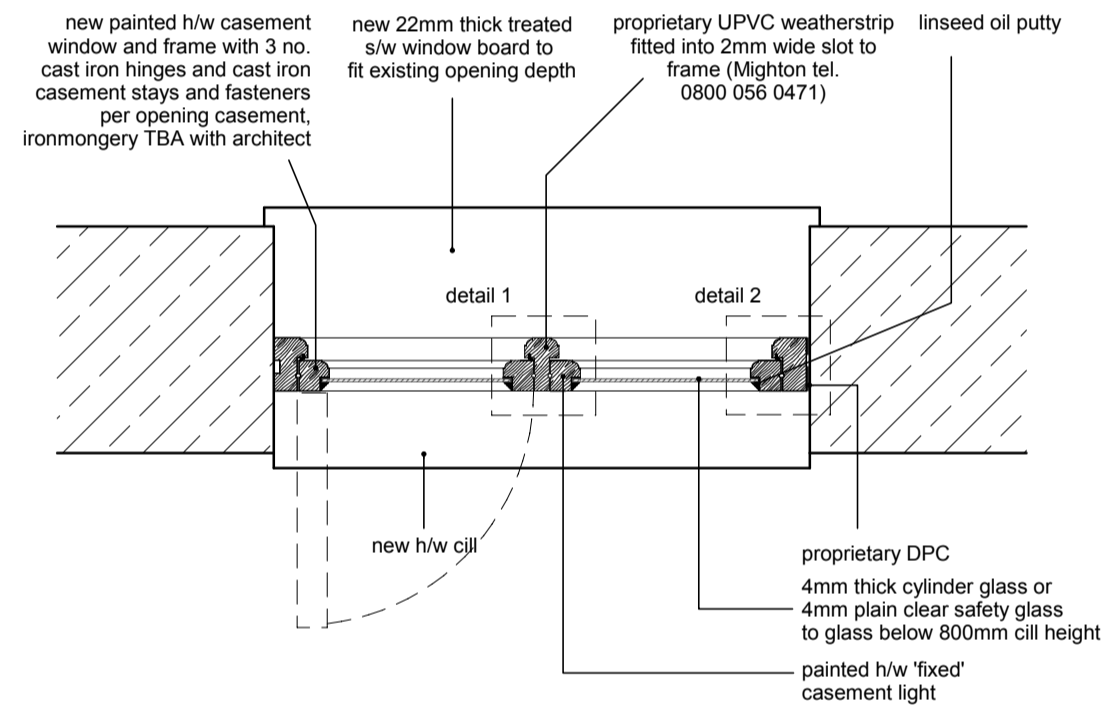

typical casement window plan
scale 1:10

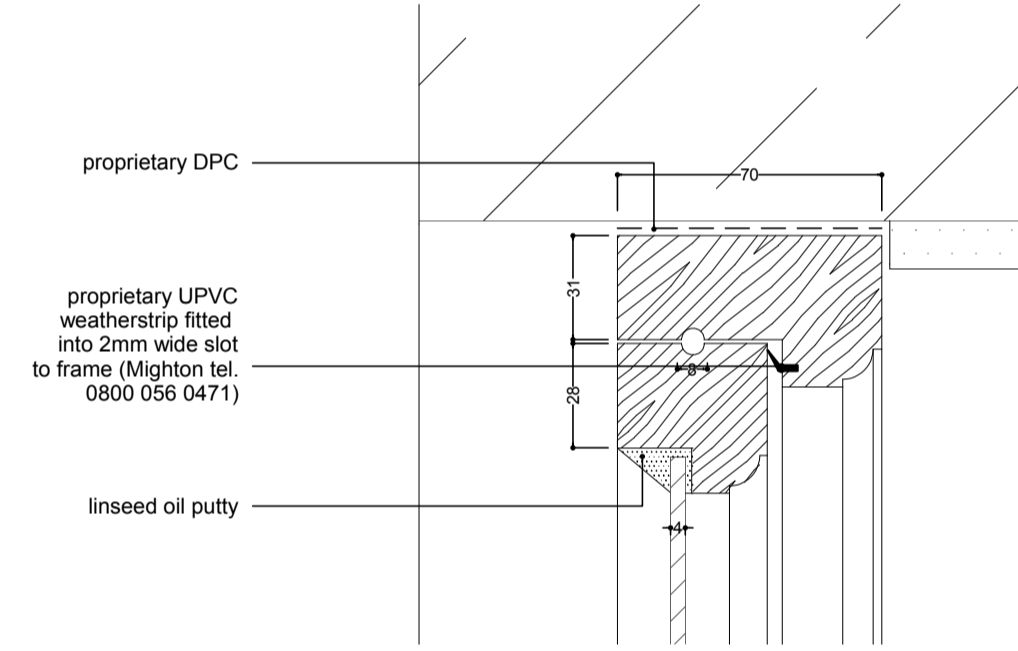

detail 5
scale 1:2

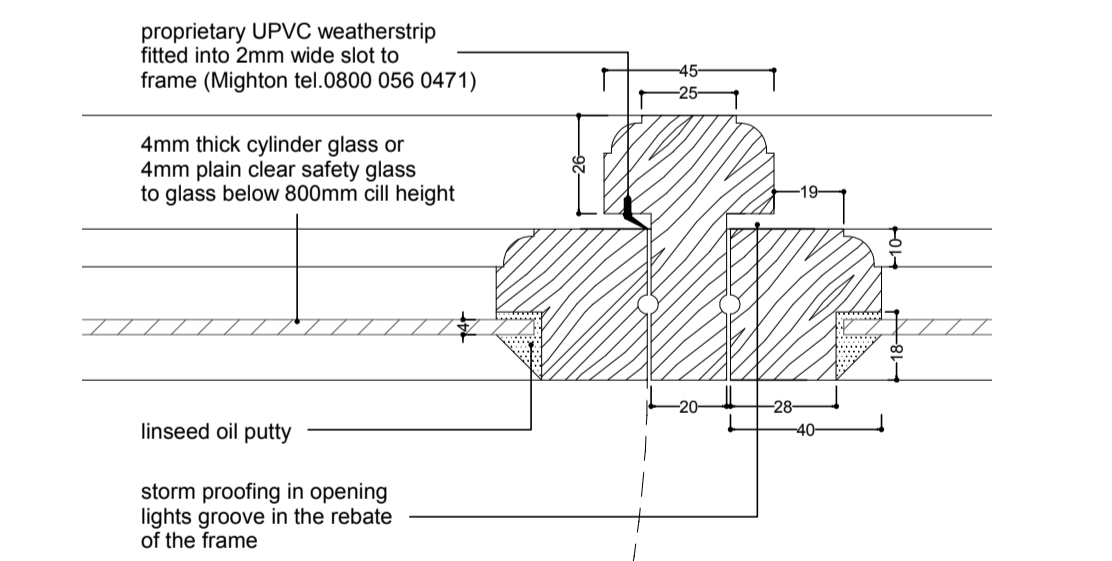

detail 4
scale 1:2

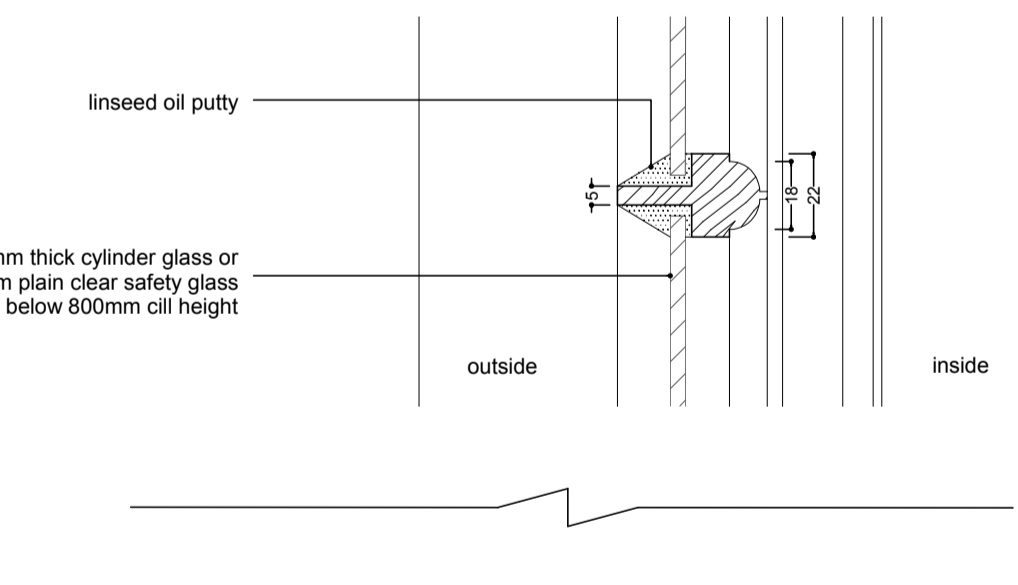

detail 1
scale 1:2

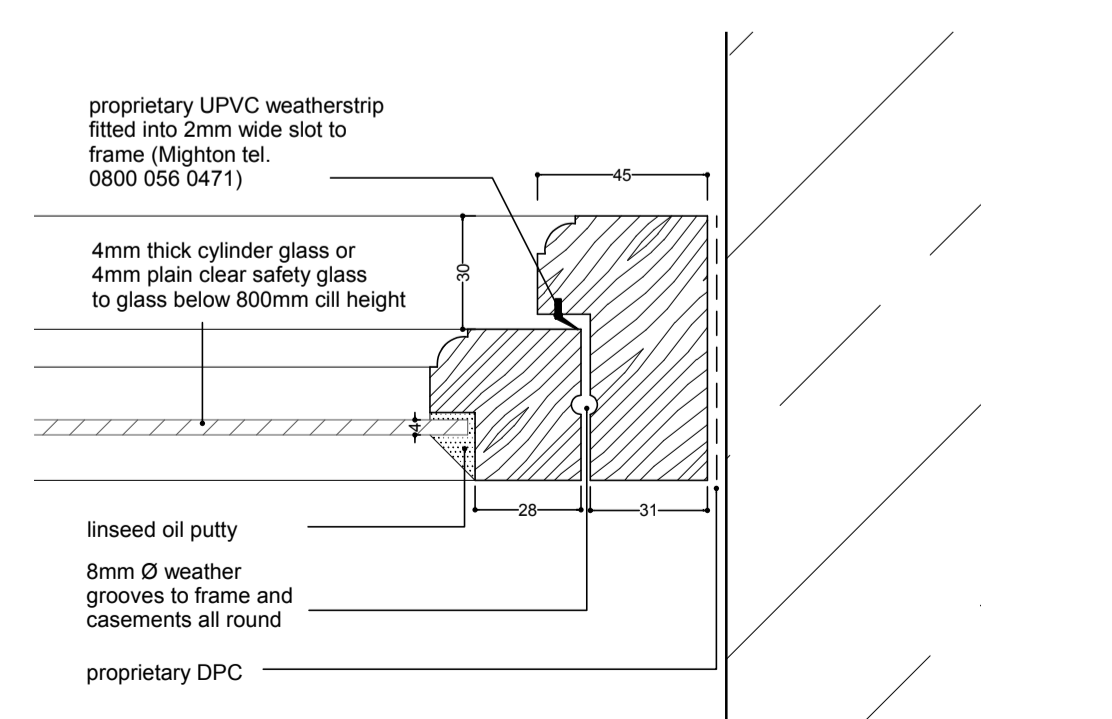

detail 2
scale 1:2

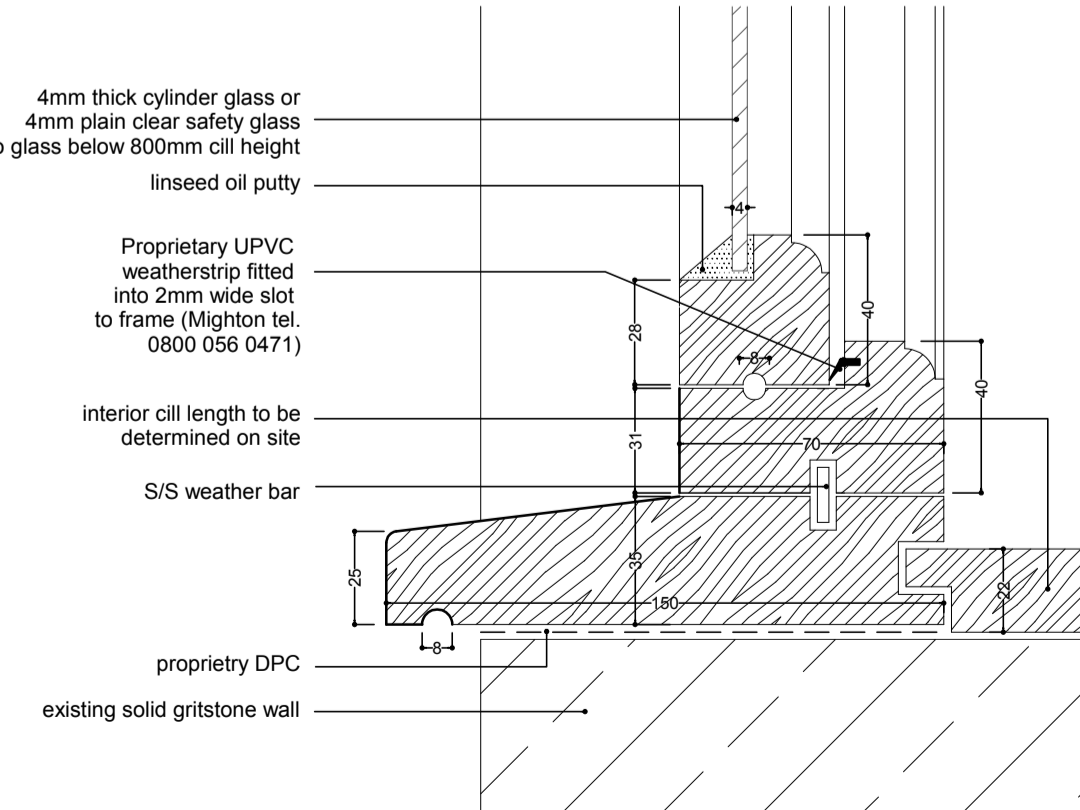

detail 3
scale 1:2

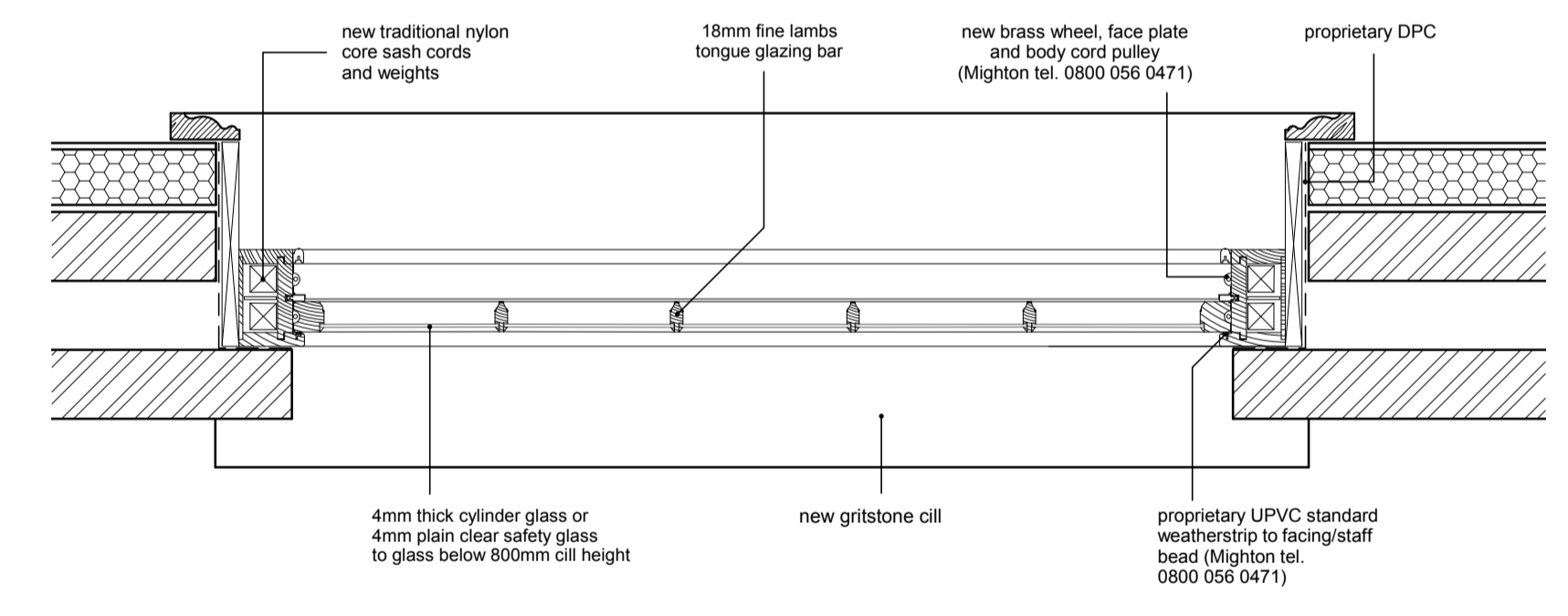

new double hung vertically sliding sash window to W3 plan
scale 1:10

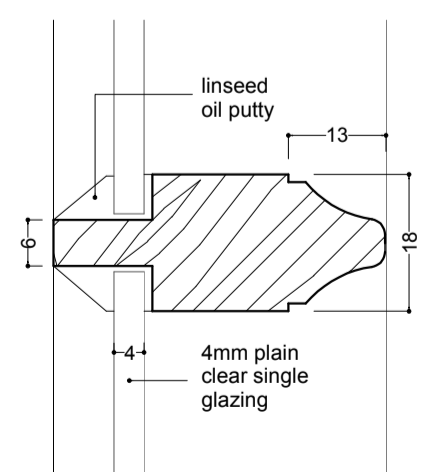

detail 7
scale 1:1

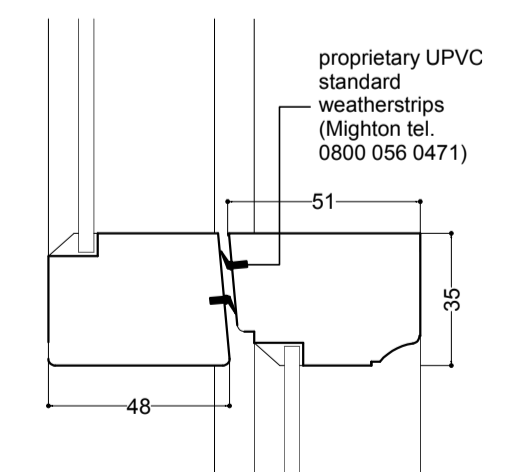

detail 6
scale 1:2

Rev	Date	Drawn	Description

Clerk Bank House
 Clerk Bank
 LEEK
 Staffordshire
 ST13 5HE
 Tel: 01538 373 477
 Fax: 01538 386 503
 e: info@ctdarchitects.co.uk
 architects historic building
 advisors | project managers |
 landscape & urban designers

Client
Rachel Trafford
 Project
Haregate Hall, 17th Century House
 conservation repairs, reinstatement &
 conversion of Grade II Listed house
 Title
**window details to dwelling two :
 as proposed**

Status
PLANNING & LBC

Scale: 1:10	A1	Size	Job No: 1345
Drawn: LC	CH	Chk'd	Date: Nov 2013
File path: \\drawing\2013\1345 Haregate Hall\1345 as prop p11 etc.scd			Revision: -
Drawing Number: AL35			Revision: -