

Proposed layout

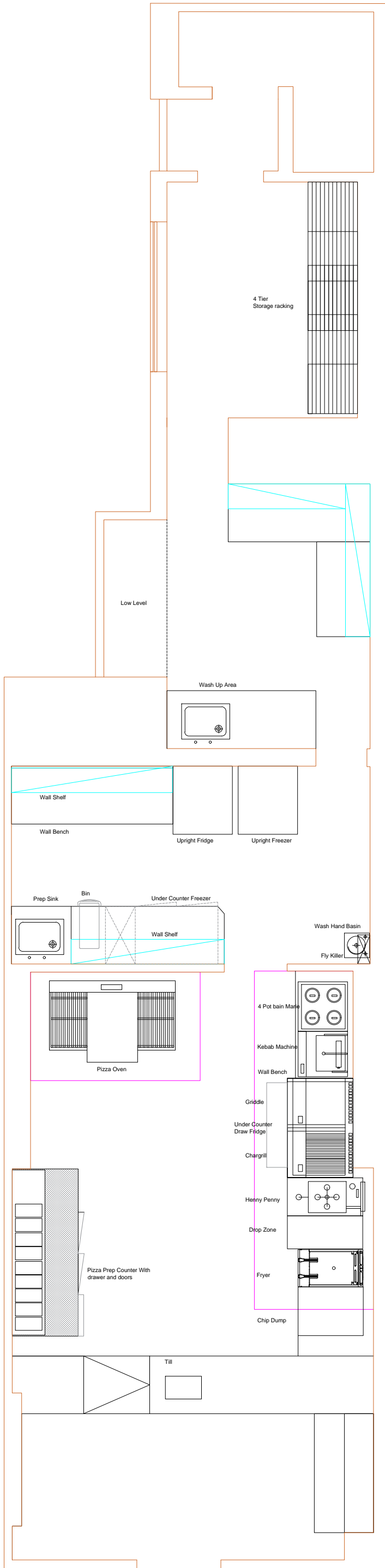

Extraction layout

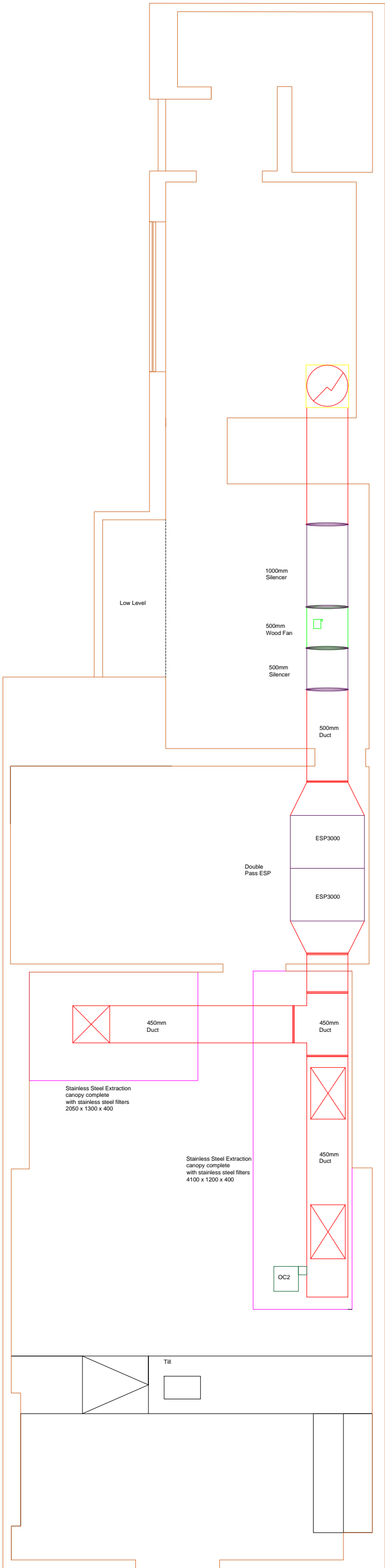

Rear View Elevation

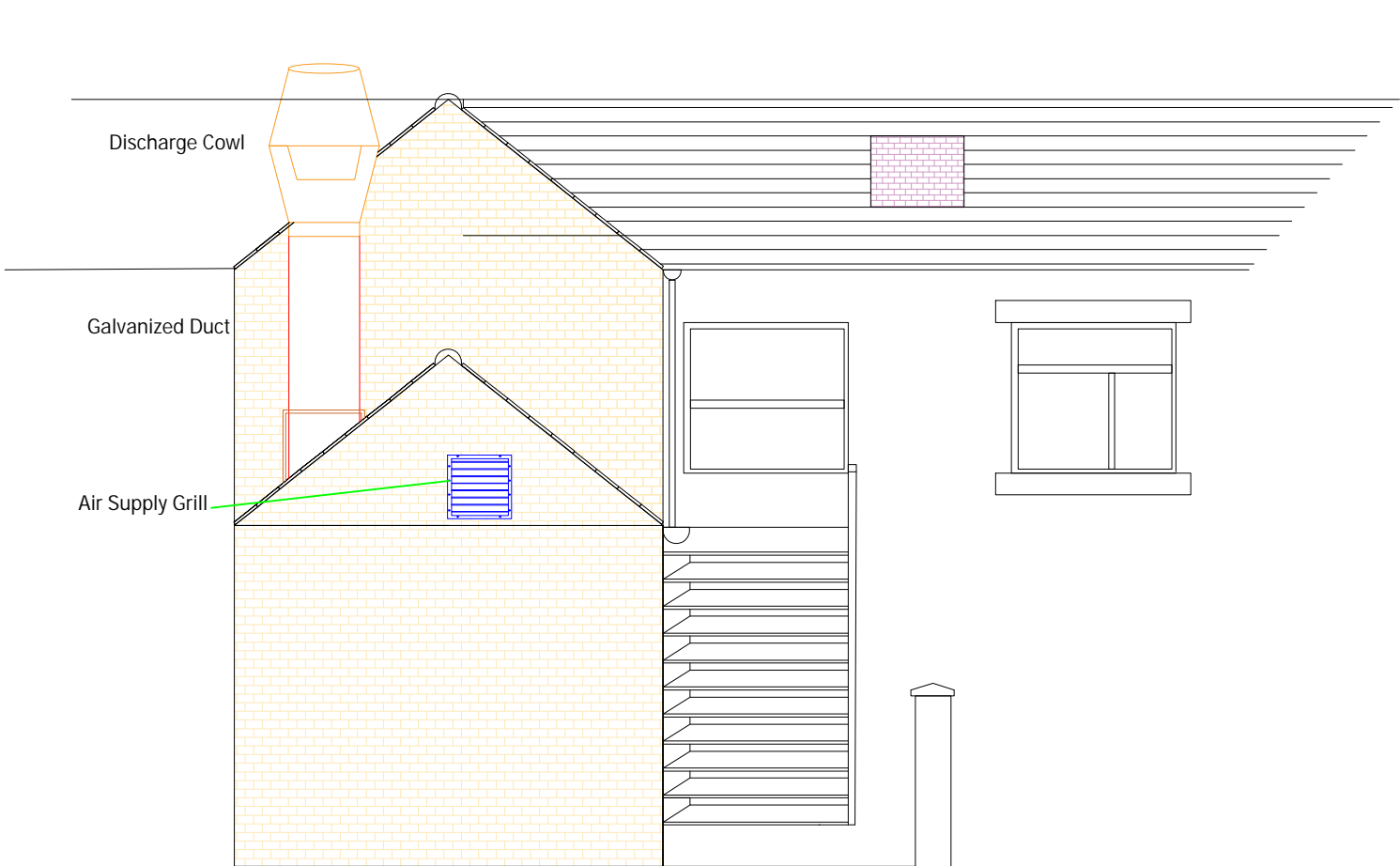

Qty	Description	Size	Coefficient	Total m3/s	<div>NOTES</div> <div>Dimensions Subject to final site survey.</div> <div>All dimensions are in millimeters with a general fabrication tolerance of +/- 1mm</div> <div>SPECIFICATION</div> <div>Canopy to be fabricated in Stainless steel with welded formed and folded construction</div> <div>INTERLOCKS</div> <div>To comply with current bs-6173:2001, mandatory interlocks are required between the gas supply and the mechanical kitchen ventilation system (extract and supply air)</div>
1	Pizza Oven	1500 x 850	0.30	0.38	
1	Gas Fryer	450 x 800	0.50	0.18	
1	Pressure Fryer	460 x 915	0.50	0.21	
1	Gas chargrill	600 x 800	0.95	0.46	
1	Gas Griddle	600 x 800	0.30	0.14	
1	Gas Kebab Machine	500 x 550	0.75	0.21	
1	Bain Maire	600 x 600	0.15	0.05	
Extract Volume Required				1.63m3/s	
Canopy Factor open Both End				1.25m3/s	
Total Extraction Flow Rate				2.04m3/s	
Supply Air @85%				1.75m3/s	
Canopy Size 2050 x 1300 x 400 Weight: 65Kg					
Canopy Size 4100 x 1200 x 400 Weight: 90Kg					
Extraction Fan		Supply Fan		Interlock System	
Model: Maxfan Compac 500mm		Model: 50JMP/20/4/6/24		Model: Merlin CT1250	
Air Flow Rate: 2.78M3/s@300Pa		Air Flow Rate: 1.91M3/s		Key operated gas proving and Interlock Compatible with current monitor, Gas detector input Dual current monitor	
Weight: 51Kg		Weight: 46Kg			
Odour Control OC2		Silencer CDA500x2D CDA500x1D			
Double Pass ESP3000					
		Roof Hood Jet Cowl 500 dia			

Scale: 1.50@A2

Ideal Catering Solutions Ltd PO Box 286 Norwich, Norfolk, NR18 8EY Tel: 07791 574539 Email: scott@idealcatering.co.uk	Client:	Emrah	Site Address: 95 High Street, Biddulph, Stoke On Trent	
	Scale:	1.50@A2	© Copyright Ideal Catering Solutions Ltd. All rights reserved. This drawing at all times remains the property of Ideal Catering Solutions Ltd and may not be reproduced in any form. Note: Do Not Scale This Drawing. All Contractors To Check Dimensions On Site Before Commencement Of Works.	
	Drawn By:	SPR		
	Status:	PROPOSED		
	Date:	22/10/2022		
	Drawing No:	IDC020318	REV: A	