

[illegible]

Dimensions shall be checked and verified prior to work being commenced on site

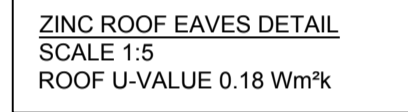

VM Zinc flashing chased into existing mortar joints and welded around bottom edge of abutment ventilator

Airtrak AB5 abutment ventilator

Zinc standing seam

150mm zinc roof upstand

Zinc roof covering

25mm counterbattens

18mm external grade plywood deck

minimum 50mm ventilation gap above roof insulation

195

VM Zinc membrane draped over rafters

63x195mm C16 timber joists @ 400mm c/s

Joists notched over 50x100mm wallplate, screwed to existing building

Existing fair-faced stone wall

Minimum 75mm Kingspan Thermapitch TP10 insulation between rafters

Minimum 57.5mm Kingspan Kooltherm K118 insulated plasterboard under rafters. Skim finish

25

Ventilated air gap

Airtrak flymesh

Airtrak AB5 abutment ventilator screwed to wall using suitable non-ferrous fixings

ZINC ROOF ABUTMENT DETAIL
SCALE 1:5
ROOF U-VALUE 0.18 Wm²K

DETAIL B

ZINC ROOF ABUTMENT DETAIL
SCALE 1:5
ROOF U-VALUE 0.18 Wm²k

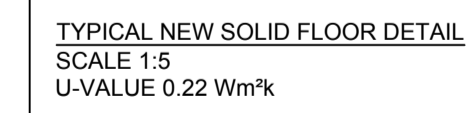

Metres

01 02 03 04 05 10

SCALE 1:50

Architects
Historic Building Consultants
Atlas House
Old Hall Street
Macclesfield Cheshire SK10 2DT
Telephone 01625 426218
Fax 01625 511 732
hp@hayesandpartners.co.uk

scale	1:5 @A1		
date	June 2018		
drawn	KM	checked	CM
number	3590_20_01		revision A