

Copyright of this drawing is vested in the Architect and it must not be copied or reproduced in any form without the written consent of the Architect. The Architect is not responsible for any errors or omissions in this drawing and is not responsible for any loss or damage arising from the use of this drawing. All dimensions must be checked and verified by the client. This drawing is for information only and is not to be used for any other purpose. The client is advised to check all dimensions relative to their work. Hewitt&Carr Architects Ltd are to be advised of any variation between drawings and site conditions. **CLIENTS ARE ADVISED TO CLARIFY DIMENSIONS WITH THE ARCHITECT PRIOR TO SETTING OUT AND NOT TO SCALE FROM THE DRAWING**

Rev.	Down	Comments	Date
B	KEW	Levels added	Apr 18
C	KEW	Do Not Scale removed	Jul 18

Hewitt&Carr Architects
A: The Studio 17A High Street | Cheshire | Staffordshire | ST10 1AA
T: 07803 2562299 | 07971 396376
E: enquiries@hccarchitects.co.uk
W: www.hccarchitects.co.uk

Client
Mr H Wainscott

Project
Proposed Conversion of Barns to
Residential Accommodation
Red Morley Farm, Winkhill, Staffs

Title
Site Block Plan as Existing

Status
Survey

Date
Sept 2013

Scale @A2
As Stated

Project No
00225

Drawing No.
AL(0)15

Rev
C

Drawn
SG

Checked

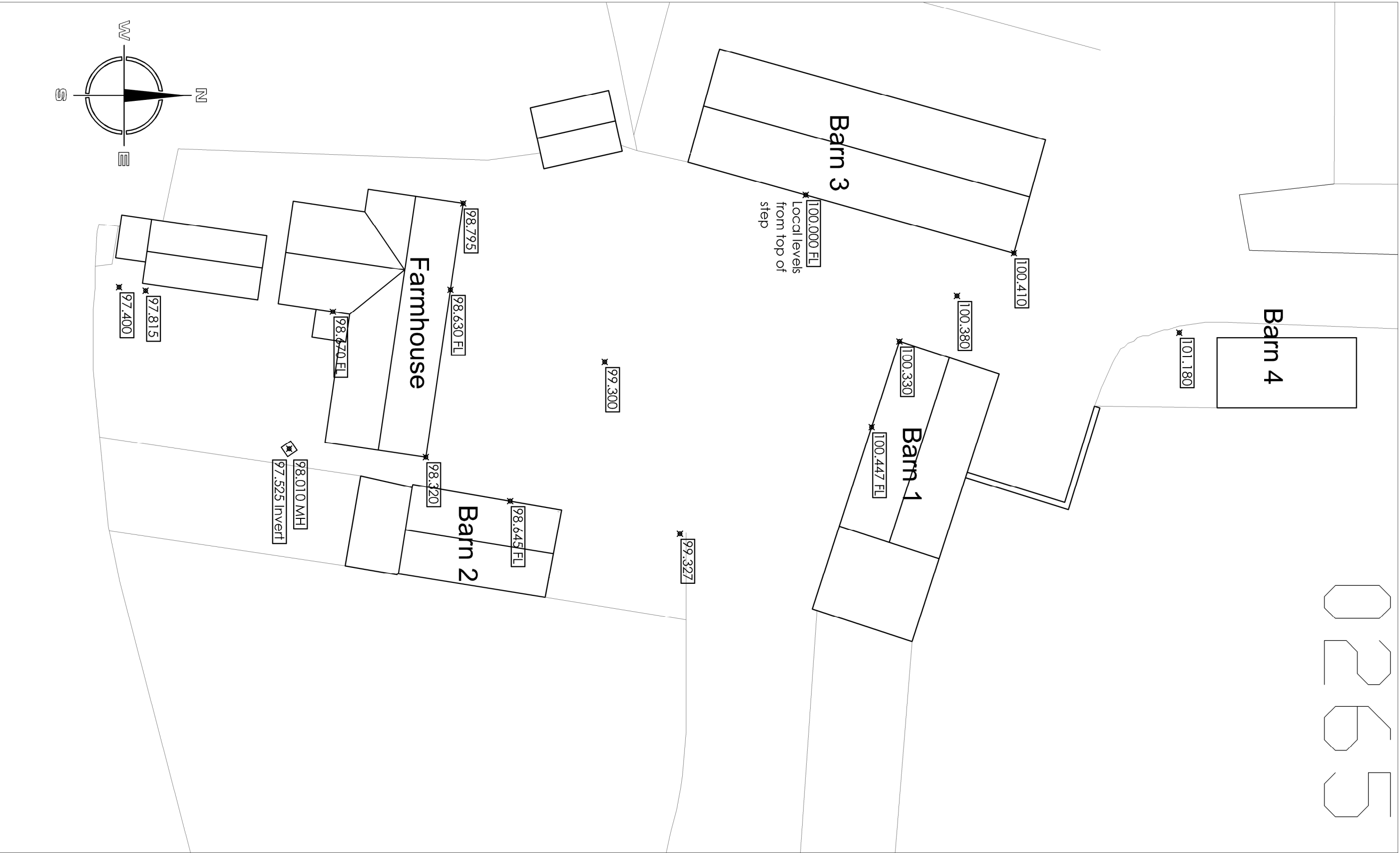

SITE PLAN 1:200

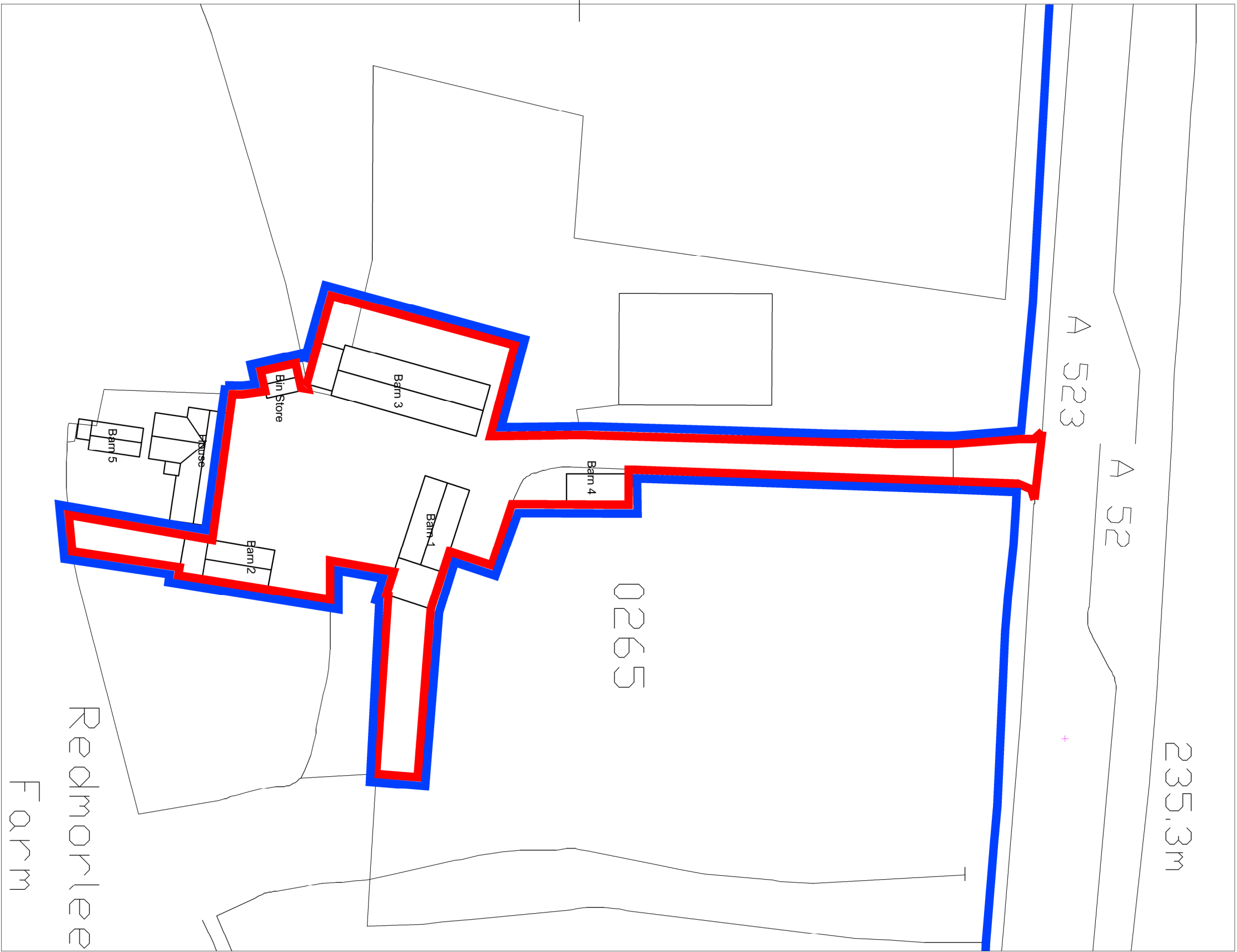

SITE PLAN 1:500