



Daisybank House

Installation : Proposed new lighting

Project number : QUO-06116-J7K0L1
Customer : Premier Elect Wholesaler
Processed by : Antonio Formisano
Date : 29.05.2018

Project description:

Calculation based on standard reflectances.

Room/exterior area dimensions and floor to ceiling/mounting heights issued from wholesaler.

PLEASE NOTE: All room/exterior area dimensions to be checked on-site prior to installation.

Lighting designed to CIBSE guidelines where applicable and/or client requirements, all stated lux values are for overall averages across the room reference plane.

If dimmable luminaires have been specified, then it is the responsibility of the contractor to establish which dimming ballasts/system is required by the lighting control ethos/specification.

Emergency lighting design conforms to BS5266/EN1838 where applicable. Please note that 'points of emphasis' such as locations of fire fighting equipment also require emergency lighting, these locations are to be confirmed by contractor. Please note that the emergency lighting calculation MUST be produced using the emergency lighting calculation facility within this program, failure to use the correct method will show false results.

Building Regulations defines the size of open area that must have emergency lighting is given to any room larger than 60m². Any area smaller than 60m² will still have emergency fittings within them, but will not have an emergency calculation needed. Emergency escape routes or areas of hazard will require 1lx minimum throughout, while open areas will only require 0.5lx minimum throughout.

Location of critical emergency items (Plant or Switch rooms location of task, Reception telephone, First Aid Points, Extinguisher points, Call points, push bars, fire panels, etc.) are not present on issued drawings, therefore higher require lux levels under emergency conditions cannot be design in this stage.

The following values are based on exact calculations on calibrated lamps, luminaires and their arrangement. In practice, gradual divergences can occur.
Please Note: Ansell does not suggest this design because it doesn't comply with Secured by Design

Guarantee claims for luminaire data are excluded.

Relux and the luminaire manufacturers accept no liability for consequential damage and damage which is occasioned to the user or to third parties.

Lighting Design produced by
Ansell Lighting Design Department

Object : Daisybank House
 Installation : Proposed new lighting
 Project number : QUO-06116-J7K0L1
 Date : 29.05.2018



1 Luminaire data

1.1 ANSELL, AMENITY - Taurus LED (ATALEDB/1000)

1.1.1 Data sheet

Manufacturer: ANSELL



ATALEDB/1000 **Bollard / pole mounted luminaires** **AMENITY - Taurus LED**

ATALEDB/1000

Amenity

Taurus LED

Supplied c/w Integral Driver

- Robust die-cast aluminium bollard with a textured graphite finish
- Die-cast aluminium head with polycarbonate lens
- Comparable performance to 70W HQI
- Integral emergency option
- Supplied c/w root mounting kit
- LED lifespan L70 57,000 hours
- Non-dimmable

- Suitable for external use only
- 2 Year Product Warranty
- IP65

Luminaire arrangement for:

ATALEDB/1000

ATALEDB_H :

Position is the LDC position of the luminaire.

Position			Rotation		
x[m]	y[m]	z[m]	Z[°]	C0[°]	C90[°]
0.000	0.000	0.880	0	0	0

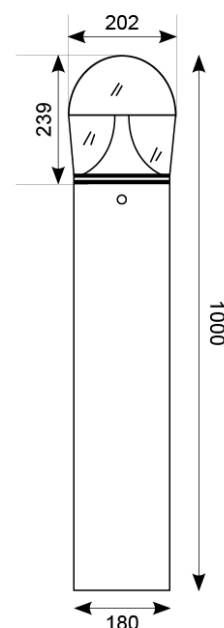

Object : Daisybank House
Installation : Proposed new lighting
Project number : QUO-06116-J7K0L1
Date : 29.05.2018



1 Luminaire data

1.1 ANSELL, AMENITY - Taurus LED (ATALEDB/1000)

1.1.1 Data sheet

ATALEDB_H

Luminaire data

Absolute Photometry
Luminaire efficacy : 53.05 lm/W
Classification : A20 ↓ 100.0% ↑ 0.0%
CIE Flux Codes : 24 66 93 100 100
UGR 4H 8H : 25.2 / 25.1
Control gear : Electronic ballast
Power : 26 W
Luminous flux : 1379.4 lm

Equipped with

Quantity : 1
Designation :
Colour :

Dimensions : Ø202 mm x 239 mm

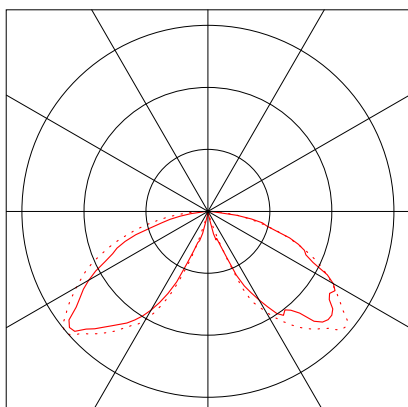

Object : Daisybank House
Installation : Proposed new lighting
Project number : QUO-06116-J7K0L1
Date : 29.05.2018



2 Exterior 1

2.1 Description, Exterior 1

2.1.1 Floor plan



Lighting Design produced by
Ansell Lighting Design Department

Object : Daisybank House
 Installation : Proposed new lighting
 Project number : QUO-06116-J7K0L1
 Date : 29.05.2018



2 Exterior 1

2.2 Summary, Exterior 1

2.2.1 Result overview, Vehicle Path/Car Park

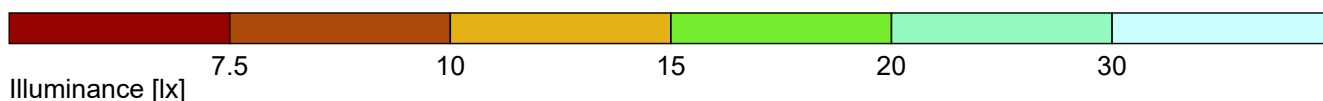
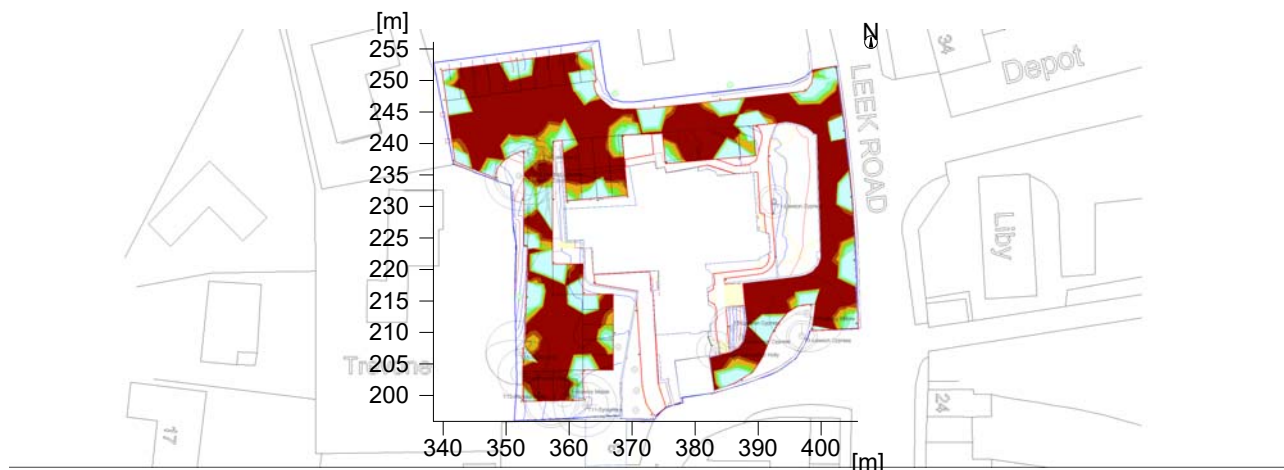

General

Calculation algorithm used	Average indirect fraction
Height of evaluation surface	0.00 m
Height (phot. centre) [m]:	0.88 m
Maintenance factor	0.80

Total luminous flux of all lamps	66144 lm
Total power	1248 W
Total power per area (2862.93 m ²)	0.44 W/m ²

Illuminance

Average illuminance	Eav	14 lx
Minimum illuminance	Emin	0 lx
Maximum illuminance	Emax	102 lx
Uniformity U _o	Emin/Em	1:33.4 (0.03)
Diversity U _d	Emin/Emax	1:249 (0)

Type No. Make

1 48 	ANSELL	
	Order No.	: ATALEDB/1000
	Luminaire name	: AMENITY - Taurus LED
	with	: 1 x ATALEDB_H
	Equipment	: 1 x 26 W / 1378 lm

Object : Daisybank House
 Installation : Proposed new lighting
 Project number : QUO-06116-J7K0L1
 Date : 29.05.2018



2.2 Summary, Exterior 1

2.2.2 Result overview, Pedestrian Path 01

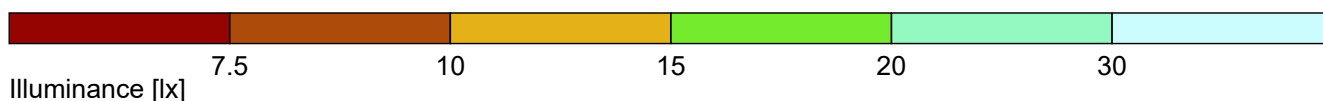
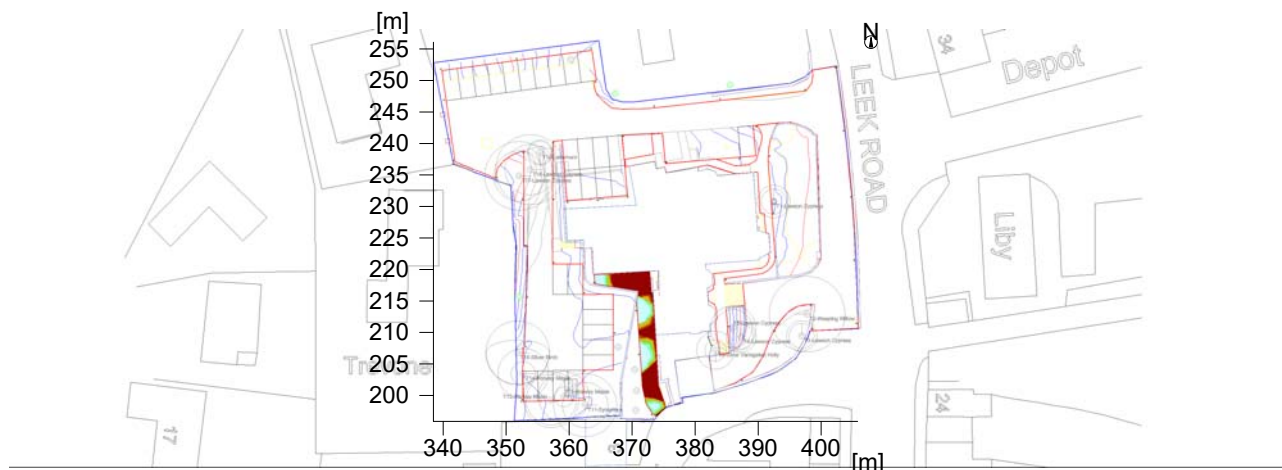

General

Calculation algorithm used	Average indirect fraction
Height of evaluation surface	0.00 m
Height (phot. centre) [m]:	0.88 m
Maintenance factor	0.80

Total luminous flux of all lamps	66144 lm
Total power	1248 W
Total power per area (2862.93 m ²)	0.44 W/m ²

Illuminance

Average illuminance	Eav	16.3 lx
Minimum illuminance	Emin	0.4 lx
Maximum illuminance	Emax	76.6 lx
Uniformity U _o	Emin/Em	1:36.9 (0.03)
Diversity U _d	Emin/Emax	1:173 (0.01)

Type No. Make

1 48 	ANSELL	
	Order No.	: ATALEDB/1000
	Luminaire name	: AMENITY - Taurus LED
	with	: 1 x ATALEDB_H
	Equipment	: 1 x 26 W / 1378 lm

Object : Daisybank House
 Installation : Proposed new lighting
 Project number : QUO-06116-J7K0L1
 Date : 29.05.2018



2.2 Summary, Exterior 1

2.2.3 Result overview, Pedestrian Path 02

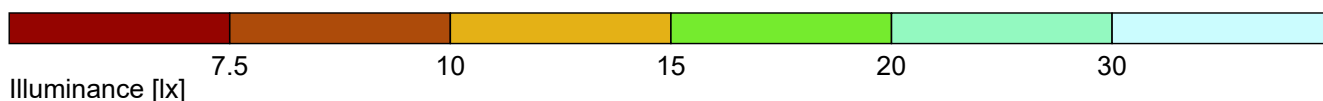

General

Calculation algorithm used	Average indirect fraction
Height of evaluation surface	0.00 m
Height (phot. centre) [m]:	0.88 m
Maintenance factor	0.80

Total luminous flux of all lamps	66144 lm
Total power	1248 W
Total power per area (2862.93 m ²)	0.44 W/m ²

Illuminance

Average illuminance	Eav	14.4 lx
Minimum illuminance	Emin	0.2 lx
Maximum illuminance	Emax	45.7 lx
Uniformity U _o	Emin/Em	1:73.7 (0.01)
Diversity U _d	Emin/Emax	1:234 (0)

Type No. Make

1 48 	ANSELL	
	Order No.	: ATALEDB/1000
	Luminaire name	: AMENITY - Taurus LED
	with	: 1 x ATALEDB_H
	Equipment	: 1 x 26 W / 1378 lm

Object : Daisybank House
Installation : Proposed new lighting
Project number : QUO-06116-J7K0L1
Date : 29.05.2018



2 Exterior 1

2.3 Calculation results, Exterior 1

2.3.1 3D luminance, View 1

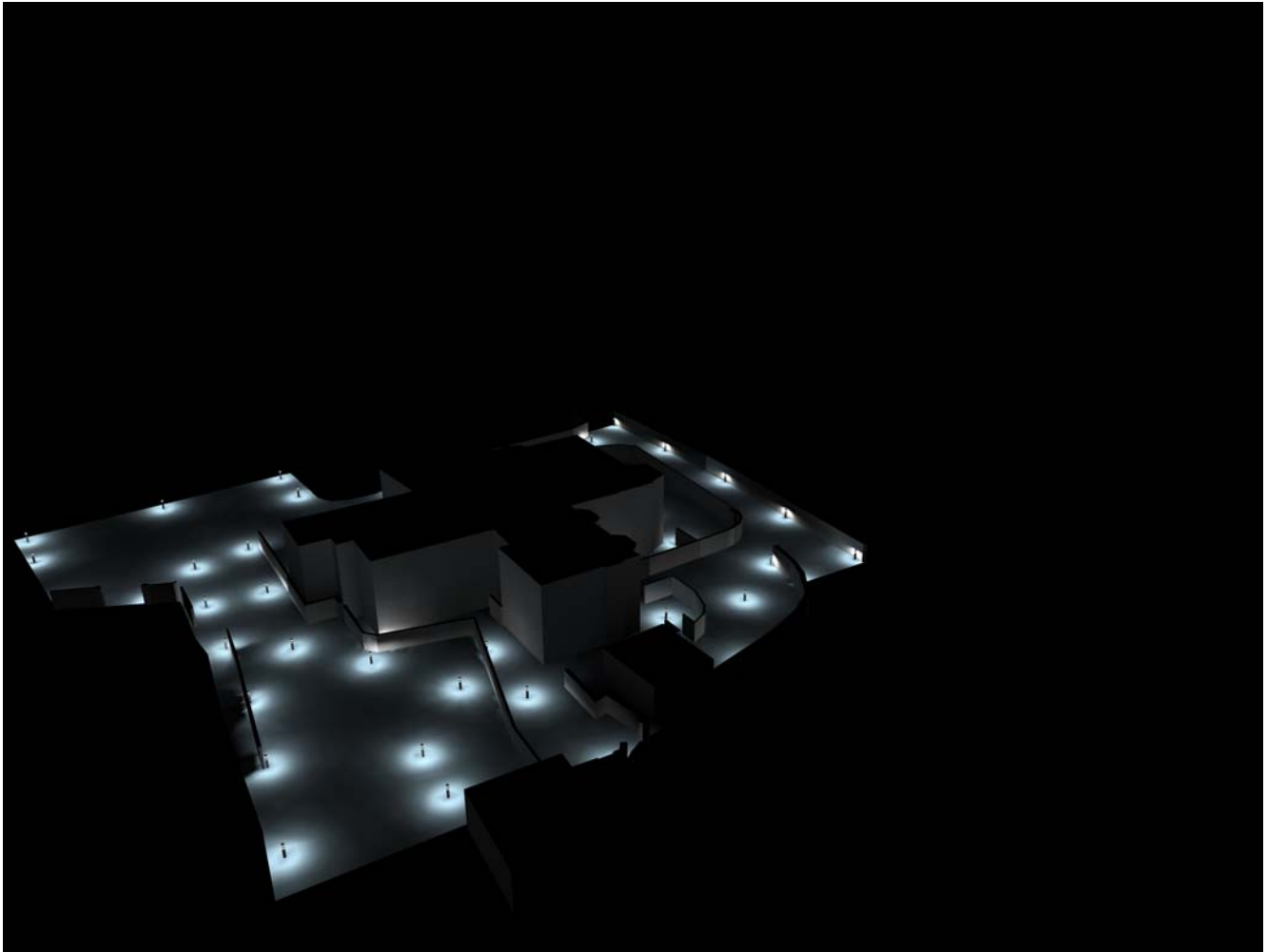

Luminance in the scene
Minimum: : 0 cd/m²
Maximum: : 848 cd/m²

Object : Daisybank House
Installation : Proposed new lighting
Project number : QUO-06116-J7K0L1
Date : 29.05.2018



2.3 Calculation results, Exterior 1

2.3.2 3D luminance, View 2

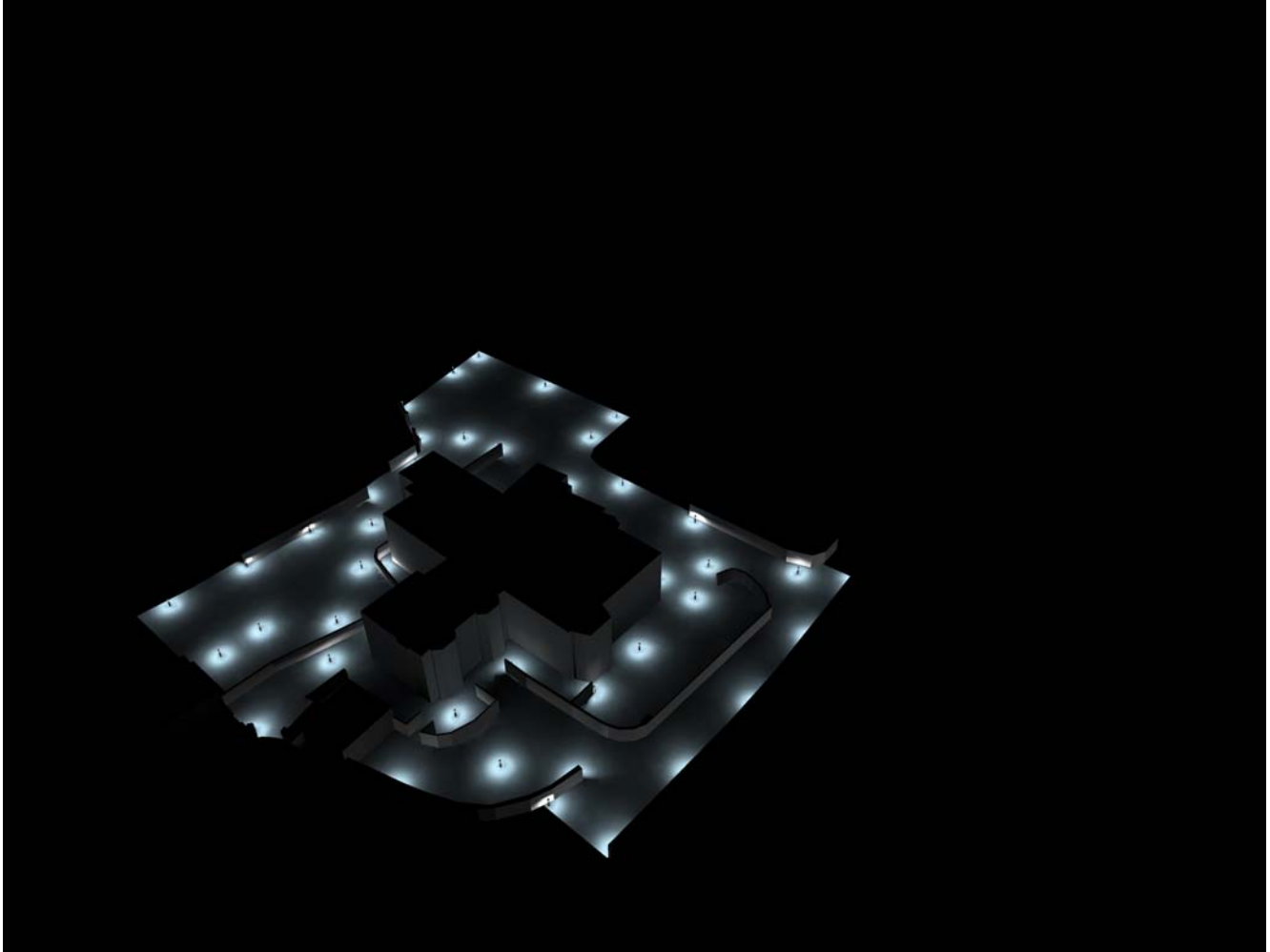

Luminance in the scene
Minimum: : 0 cd/m²
Maximum: : 848 cd/m²

Object : Daisybank House
Installation : Proposed new lighting
Project number : QUO-06116-J7K0L1
Date : 29.05.2018



2.3 Calculation results, Exterior 1

2.3.3 3D luminance, View 3

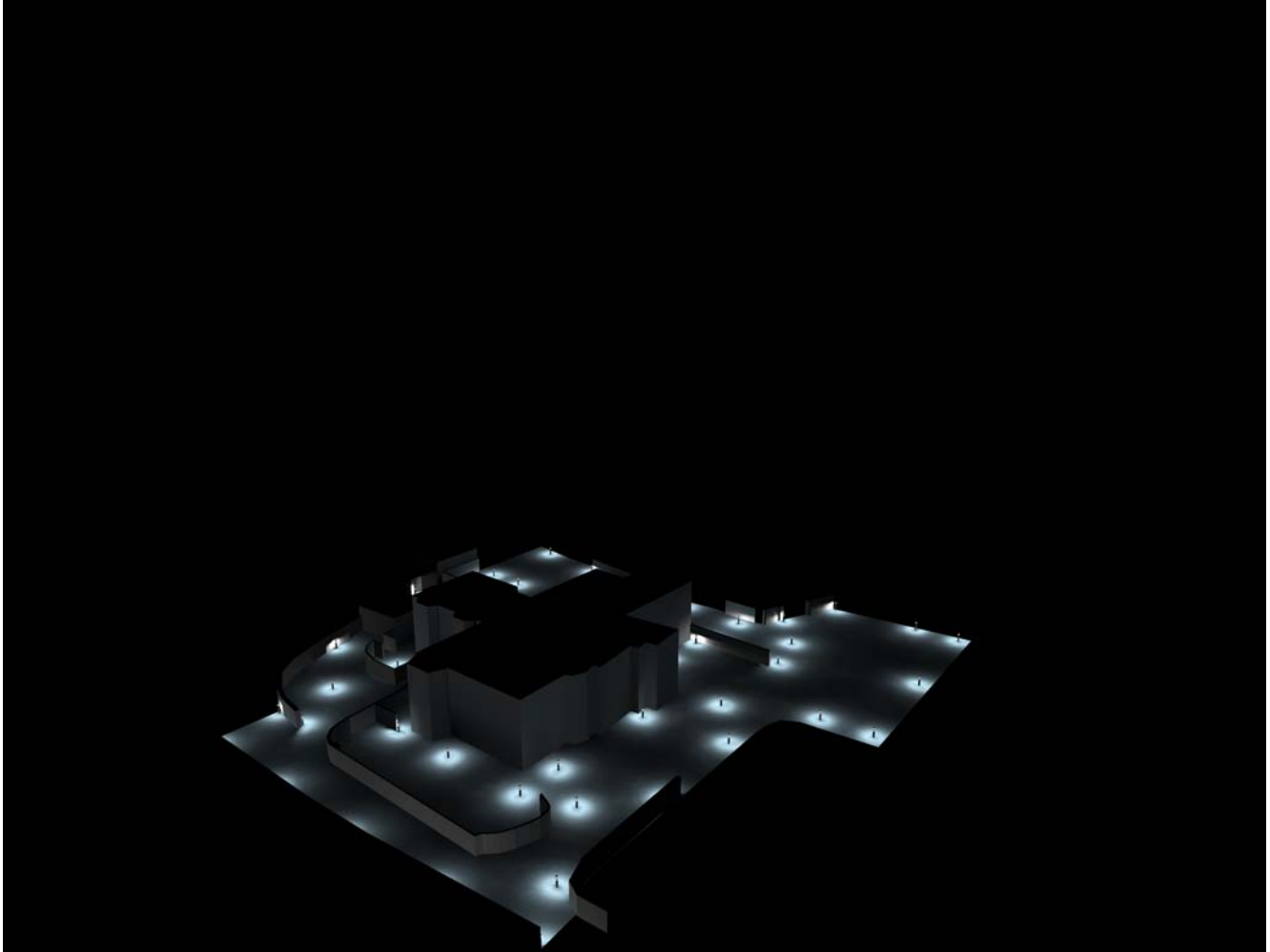

Luminance in the scene
Minimum: : 0 cd/m²
Maximum: : 848 cd/m²

Object : Daisybank House
Installation : Proposed new lighting
Project number : QUO-06116-J7K0L1
Date : 29.05.2018



2.3 Calculation results, Exterior 1

2.3.4 3D luminance, View 4

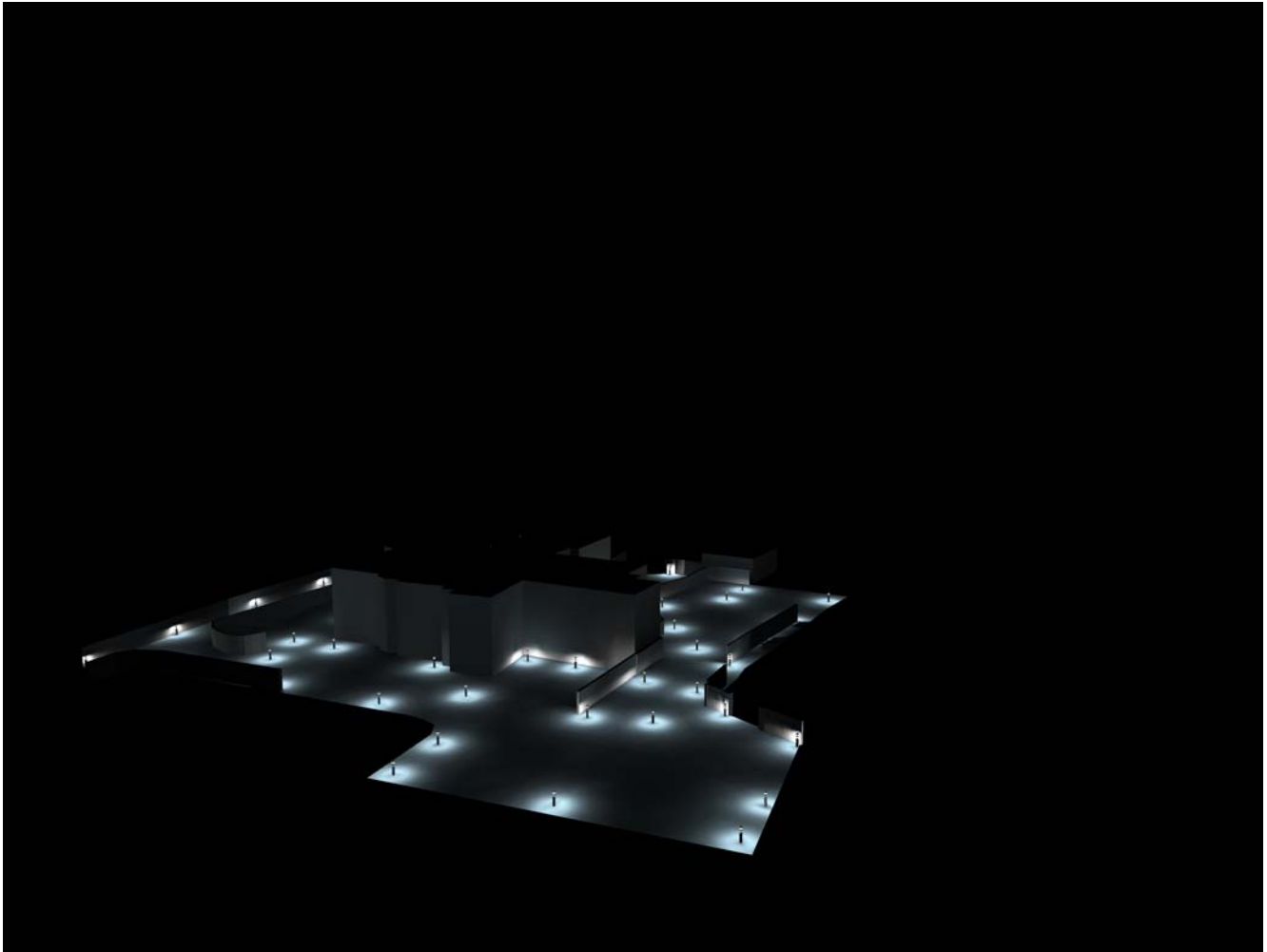

Luminance in the scene
Minimum: : 0 cd/m²
Maximum: : 848 cd/m²