

Revision

Date

REV -

Grass

Lean to element to
be demolished

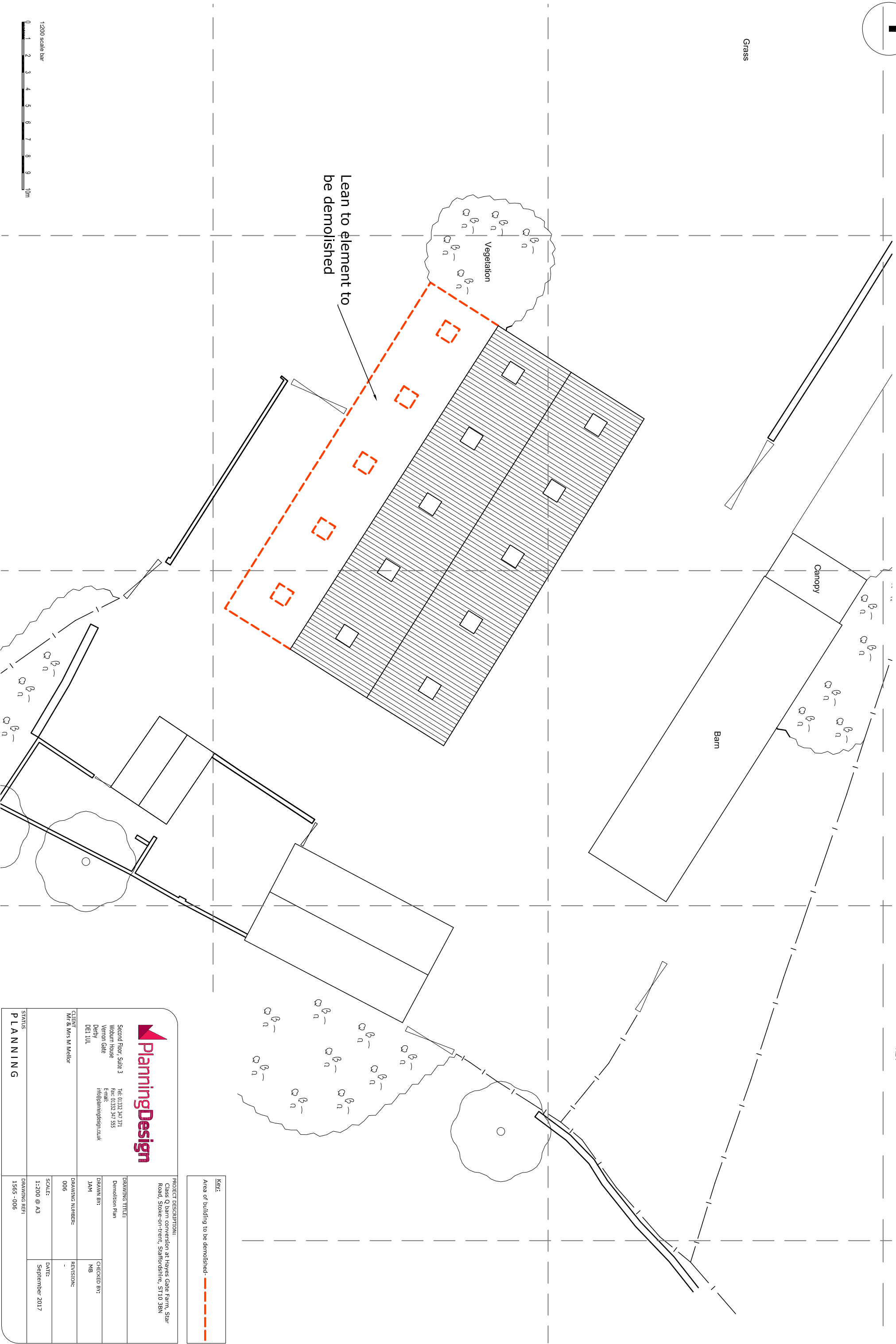

Key:
Area of building to be demolished- - - - -

<div><div><div></div><div>PlanningDesign</div></div><div><div>Second Floor, Suite 3</div><div>Wilburn House</div><div>Vernon Gate</div><div>Derby</div><div>DE1 1UL</div></div><div><div>Tel: 01332 342 371</div><div>Fax: 01332 247 255</div><div>Email: info@planningdesign.co.uk</div></div></div>			
CLIENT Mr & Mrs M Meior		DRAWING NUMBER: 006	
PROJECT DESCRIPTION: Class Q barn conversion at Haynes Gate Farm, Star Road, Stoke-on-Trent, Staffordshire, ST10 3BN		DRAWING TITLE: Demolition Plan	
DRAWN BY: JAM		CHECKED BY: MB	
SCALE: 1:200 @ A3		DATE: September 2017	
STATUS PLANNING		DRAWING REF: 1565 - 006	

© COPYRIGHT EXISTS ON THE DESIGNS AND INFORMATION SHOWN ON THIS DRAWING : The Contractor must verify all dimensions on site before making shop drawings or commencing work of any kind. No dimensions to be scaled from this drawing. Architect to be notified of any discrepancies in dimensions immediately