

NORTH EAST ELEVATION

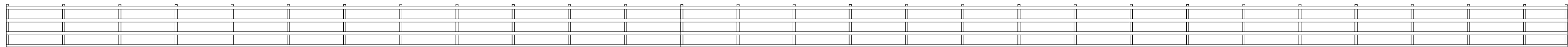

NORTH WEST ELEVATION

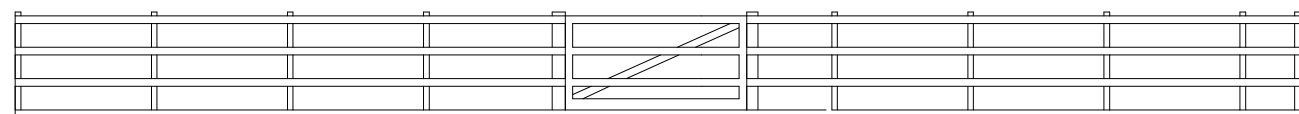

SOUTH WEST ELEVATION

NOTES

Riding arena surface to be of 225mm thickness of top quality conifer bark and wood fibre on Polyfelt TS20 membrane on minimum of 100mm thickness of crushed stone on Polyfelt TS20 membrane. Membranes to have edges heat welded at overlaps to a minimum of 300mm with edges brought up against perimeter containing boards.

Perimeter fencing to be of 150 x 75mm posts at 1800mm centres, 100 x 38mm rails (3) and 150 x 38mm containing boards at base (2).

Gate to be 1270mm high overall constructed of 100 x 75mm top rail and stiles, 75 x 25mm under rails and cross braces. Rail and brace crossings to be bolted with stainless steel bolts and all joints to be mortised and tenoned, complete with galvanized hook and band hinges and spring latch. Hanging posts to be 175 x 175mm and slutting posts to be 150 x 150mm.

External lighting to be fixed to top rail of fencing each fitted with 400W Sodium Floodlights.

Site to be left clean and tidy on completion and any damage to adjoining areas to be made good. All works to be carried out in strict accordance with all relevant BS Codes of Practice, good building practice and all relevant Health & Safety Legislation. All dimensions and levels to be checked on site.

⊠L = Lighting Point

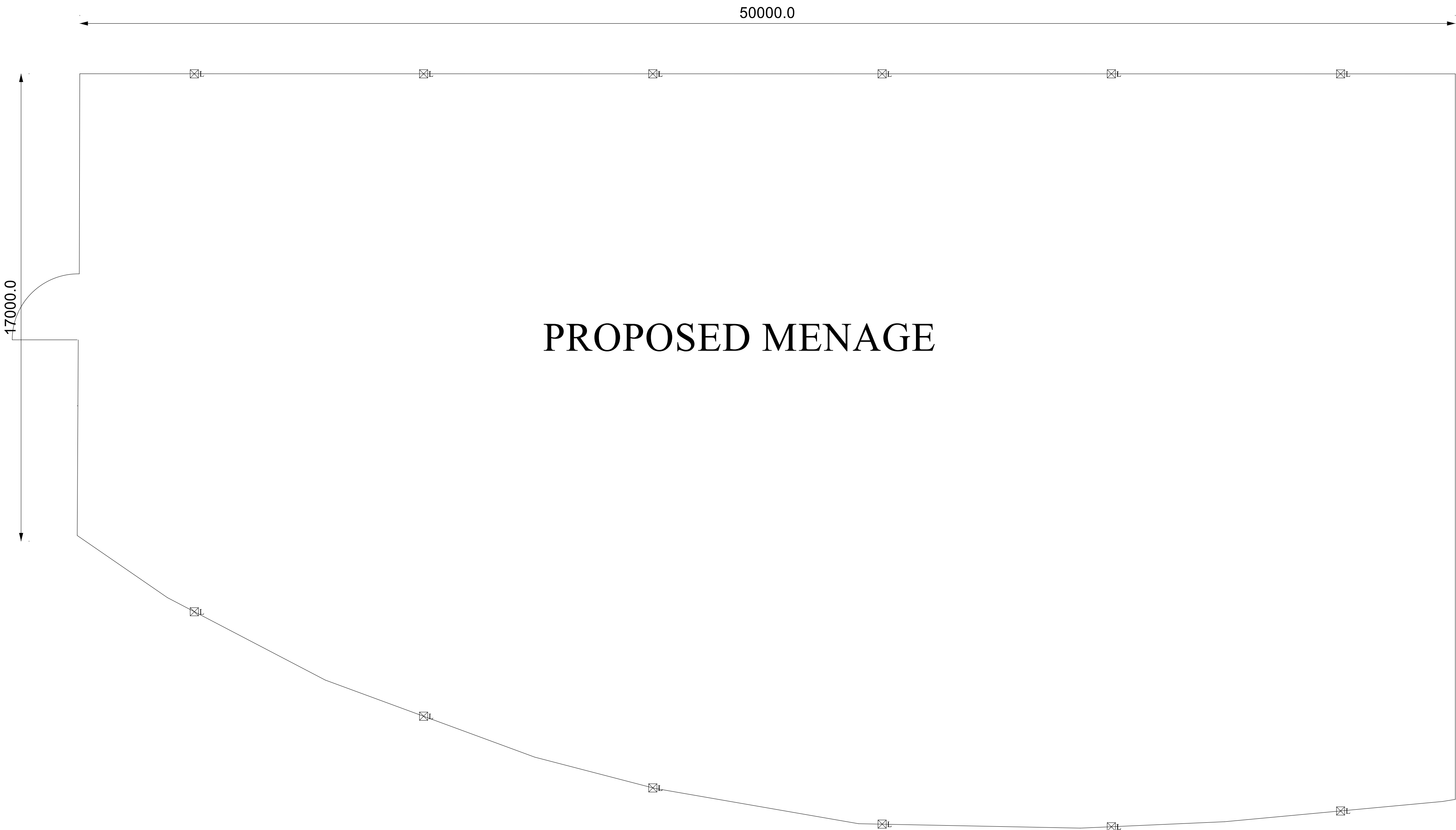

PROPOSED MENAGE

PLAN

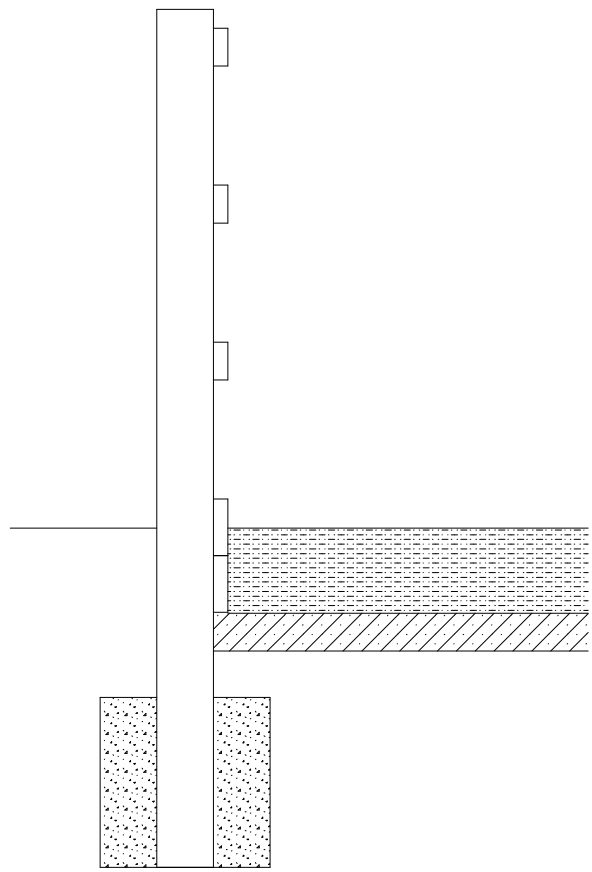

SECTION THROUGH FENCE

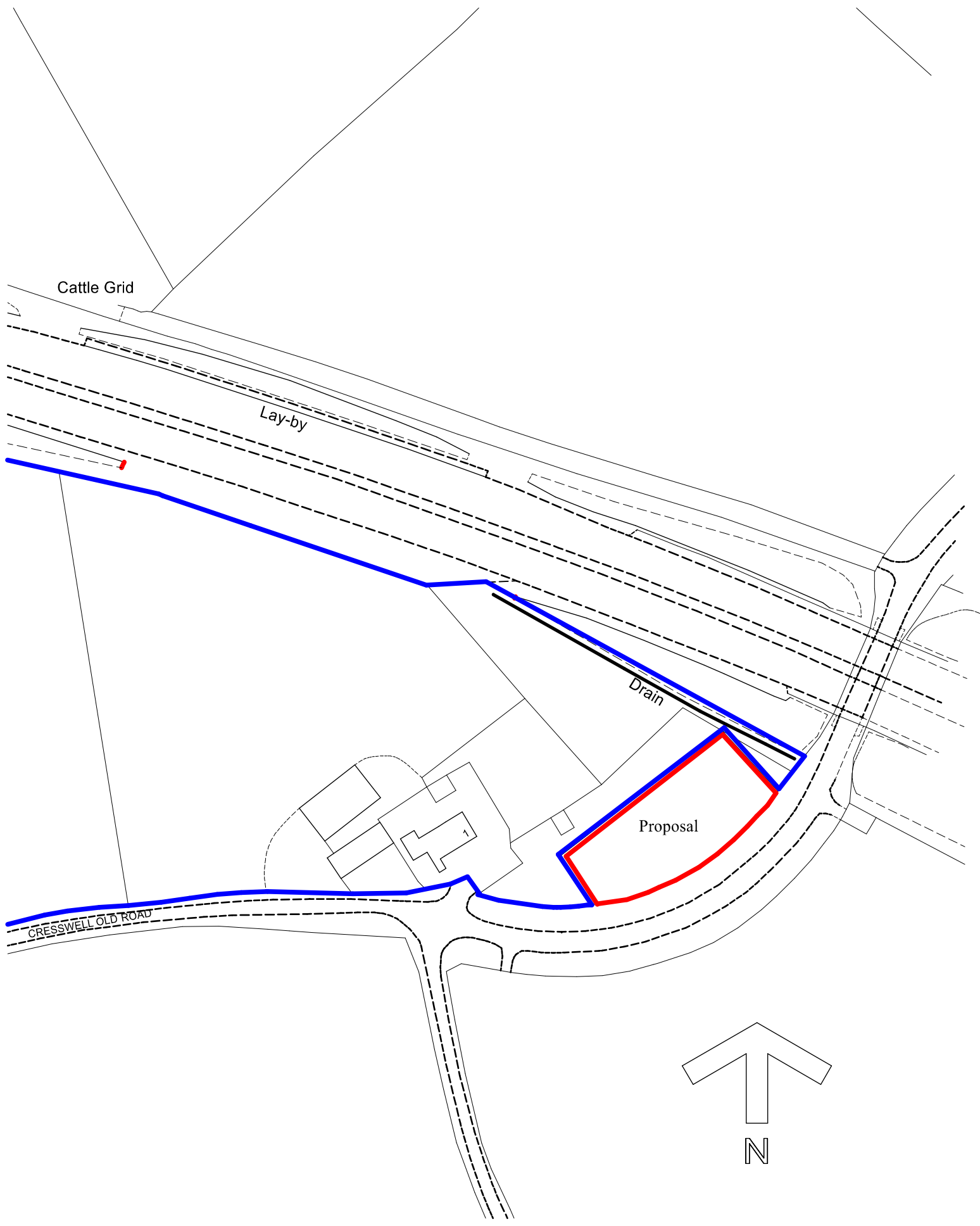

Ordnance Survey (c) Crown Copyright 2016. All rights reserved. Licence number 100022432

LOCATION PLAN

MR. L. FINLAYSON

DATE MAY 2017

PROPOSED MENAGE

AT  
1, CRESSWELL OLD ROAD,  
CRESSWELL,  
STOKE-ON-TRENT,  
ST11 9RF

SCALES:  
PLAN 1:100  
ELEVATIONS 1:20  
SECTION 1:1250  
LOCATION PLAN

DRAWN BY:

**MALCOLM SALES**  
QUANTITY SURVEYORS, DESIGNERS  
& BUILDING COST CONSULTANTS  
CURCHILL SUITE,  
LULWORTH HOUSE,  
51, HIGH STREET,  
CHEADLE, STOKE-ON-TRENT,  
STAFFS. ST10 1AR  
TEL: 01538 757233  
MOB: 07889 225437  
E-MAIL: Malcolm.sales@salesqs.co.uk

AS PROPOSED

FOR PLANNING APPLICATION

DRAWING NR. 1611/08/02