

ACCOMMODATION SCHEDULE

RETAINED ROOMS - 17No.

NEW ENSUITE ROOMS - 17No.

Total Ground Floor - 34no.

© This drawing and the works depicted are the copyright of DC Architects and may not be reproduced or amended without prior written permission. No liability will be accepted for amendments made by other parties.

O.S. information is reproduced under licence. © Crown copyright. Reproduction in whole or in part is prohibited without the prior permission of Ordnance Survey.

No dimensions are to be scaled from this drawing (indicative only).
CONTRACTOR TO SITE CHECK ALL DIMENSIONS PRIOR TO COMMENCING WORK.

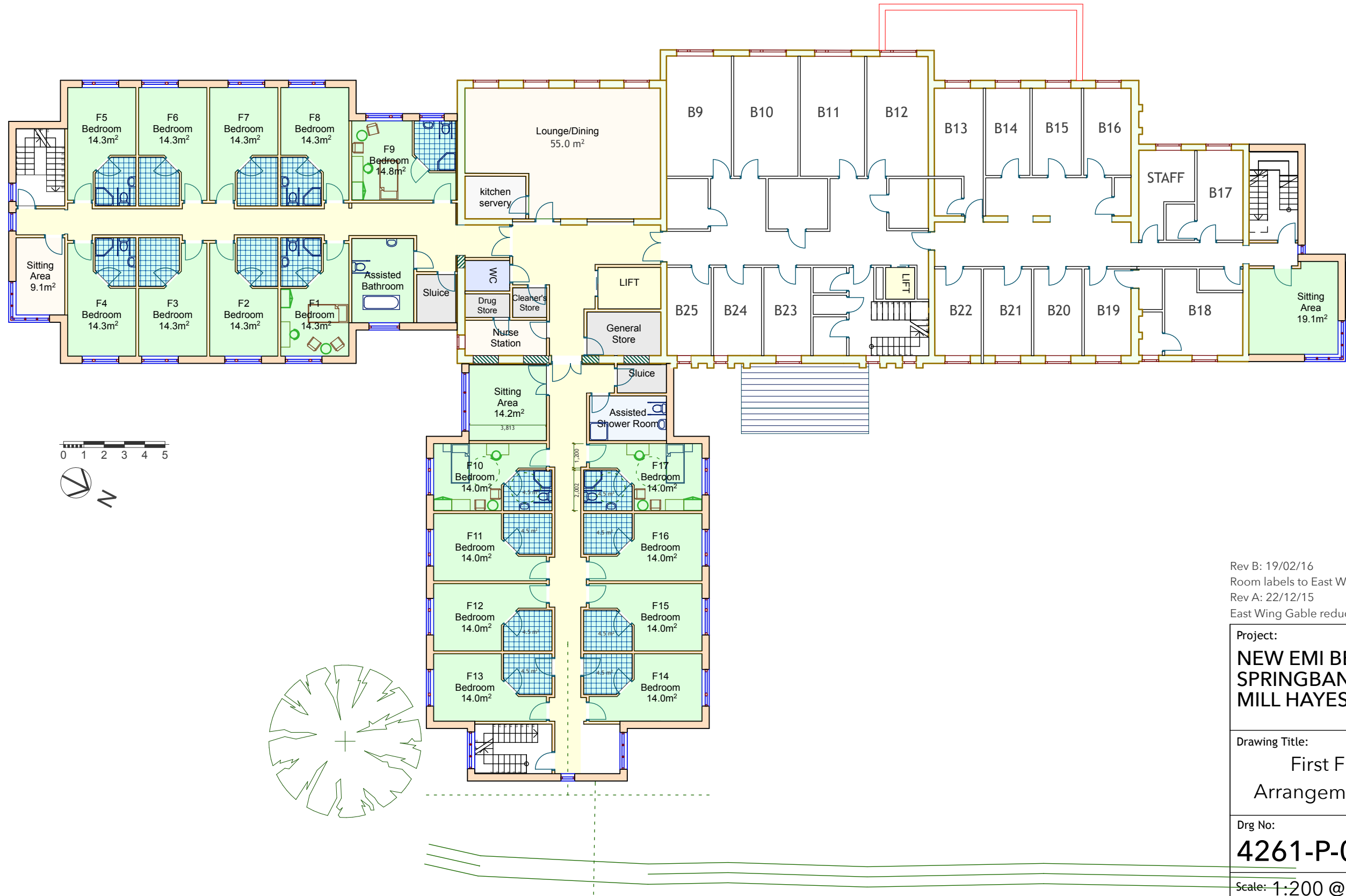

Rev B: 19/02/16
Room labels to East Wing amended.
Rev A: 22/12/15
East Wing Gable reduced, staircase amended.

Project:		
NEW EMI BEDROOM WINGS SPRINGBANK NURSING HOME MILL HAYES ROAD, BIDDULPH		
Drawing Title:		
First Floor General Arrangement As Proposed ©		
Drg No:	Rev:	Date: 04/15
4261-P-04-B		Drawn: HM
Scale: 1:200 @ A3		Checked:
DC Architects		
1-5 Short Street, Macclesfield, Cheshire, SK11 6JY Email: info@dc-architects.co.uk Tel: (01625) 466107		

First Floor General Arrangement