

**Robert L FORD**

*private architectural practitioner and rural development consultant*

**PARKSIDE PARK ROAD LEEK STAFFORDSHIRE ST13 8JT**

[robford@btopenworld.com](mailto:robford@btopenworld.com) / 01538 398290 / 07969 68 68 86

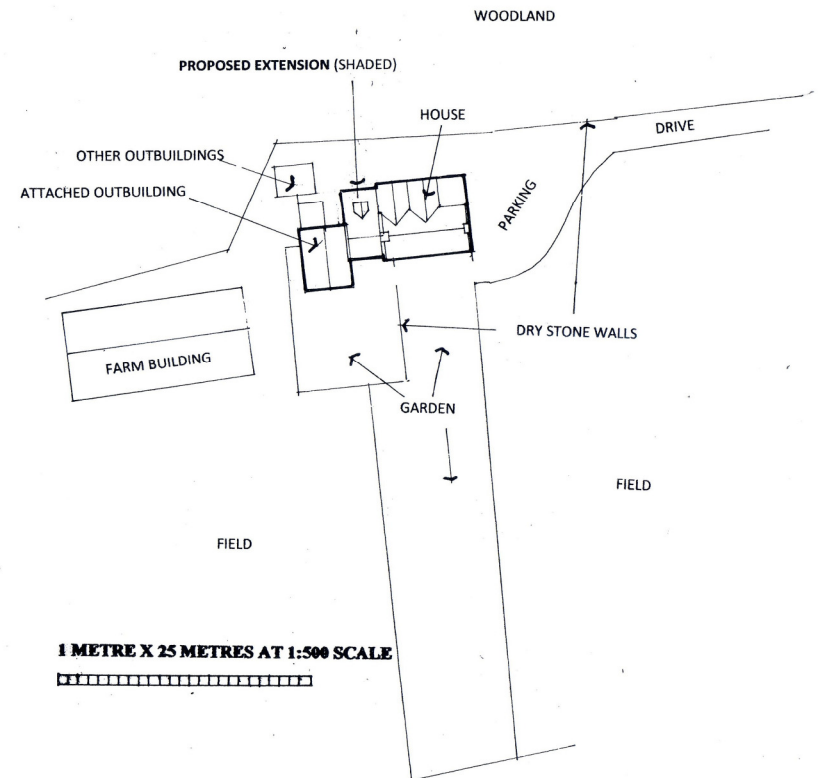

DRAWING NO. LDL 01 SITE LOCATION / BLOCK PLAN 1:1250 / 1:500 scale @A3

PROPOSED SIDE EXTENSION TO DETACHED 2 STOREY DWELLING HOUSE  
AT LIMERICK FARM DEVILS LANE LONGSDON STAFFORDSHIRE ST9 9QP

07 2015