

West elevation.

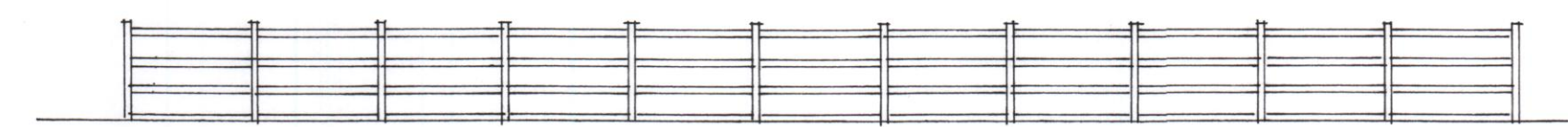

North elevation.

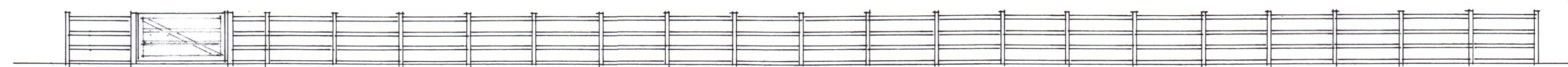

East elevation.

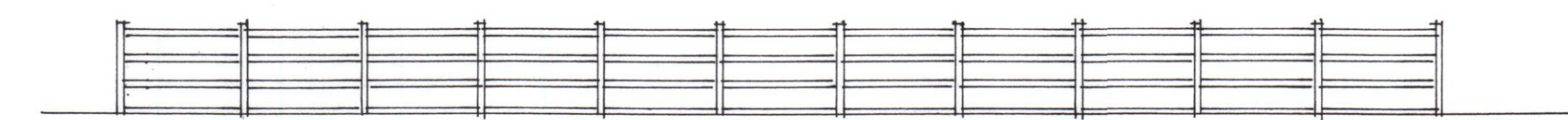

South elevation.

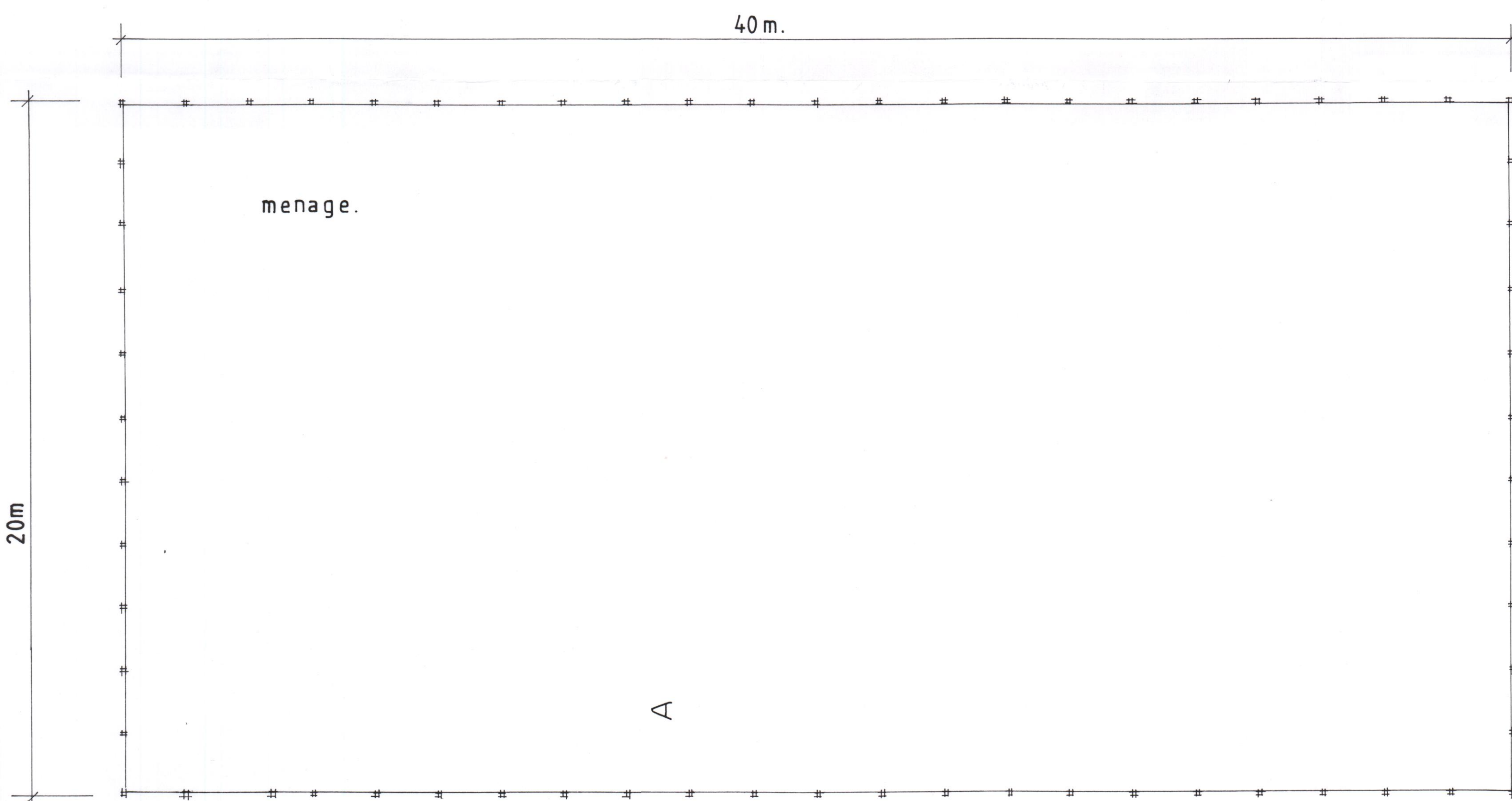

Plan.

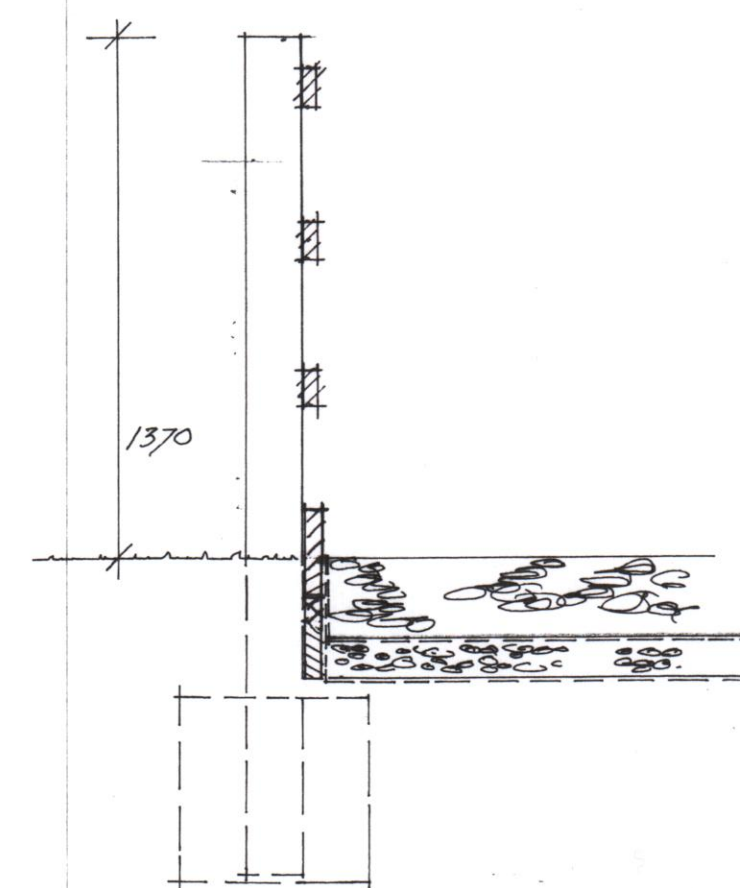

Section A. A.

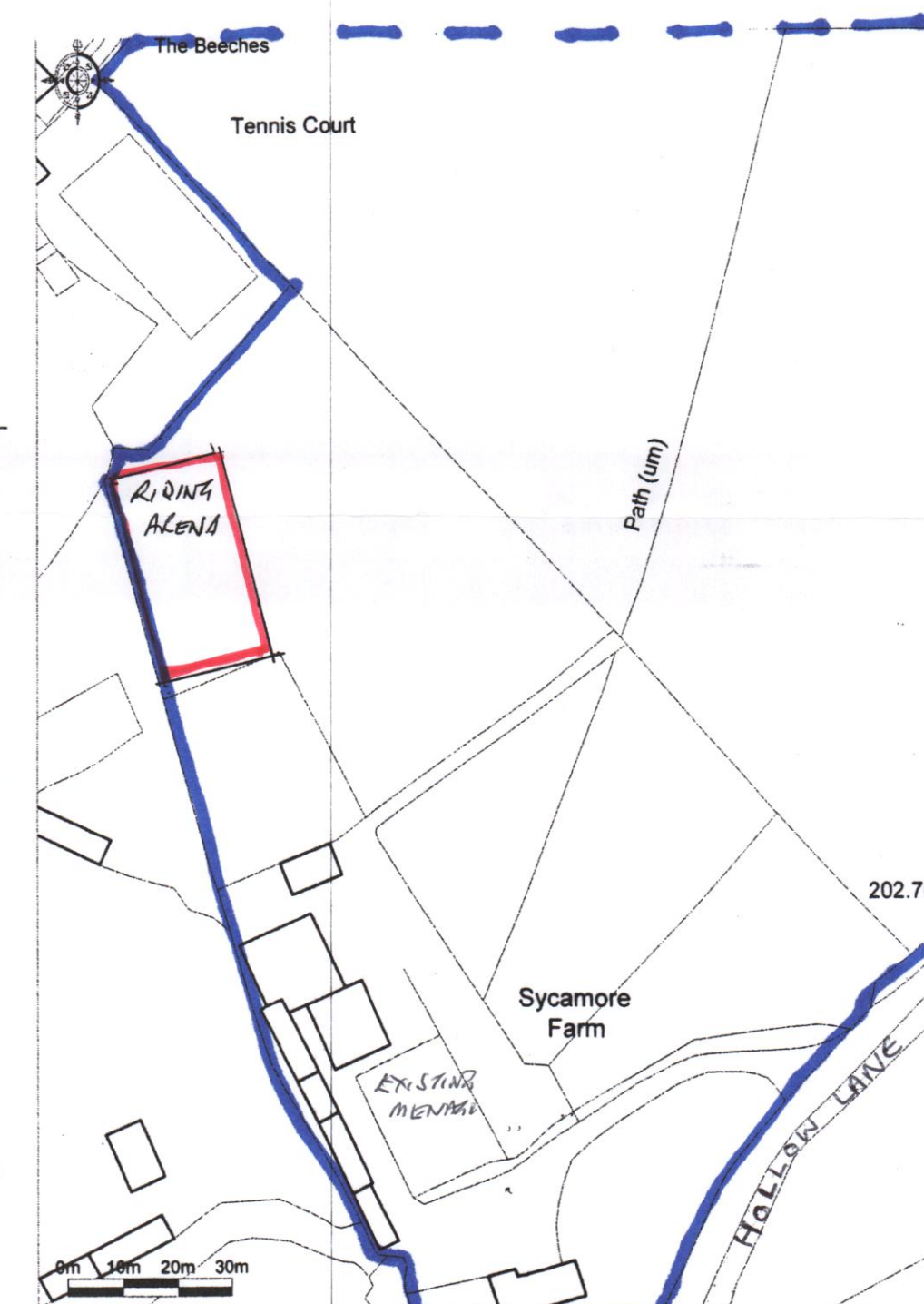

Promap  
LOCATION PLAN

Riding arena surface to be of 225mm thickness of silica sand with a fibrous binding agent on Polyfelt TS20 membrane on minimum of 100mm thickness of crushed stone on Polyfelt TS20 membrane. Membranes to have edges heat welded at overlaps to a minimum of 300mm with edges brought up against perimeter containing boards.

Perimeter fencing to be of 150 x 75mm posts at 1800mm centres, 100 x 38mm rails (3) and 150 x 38mm containing boards at base (2).

Gates to be 1270mm high overall constructed of 100 x 75mm top rail and stiles, 75 x 25mm under rails and cross braces. Rail and brace crossings to be bolted with stainless steel bolts and all joints to be mortised and tenoned, complete with galvanized hook and band hinges and spring latch. Hanging posts to be 175 x 175mm and shutting posts to be 150 x 150mm.

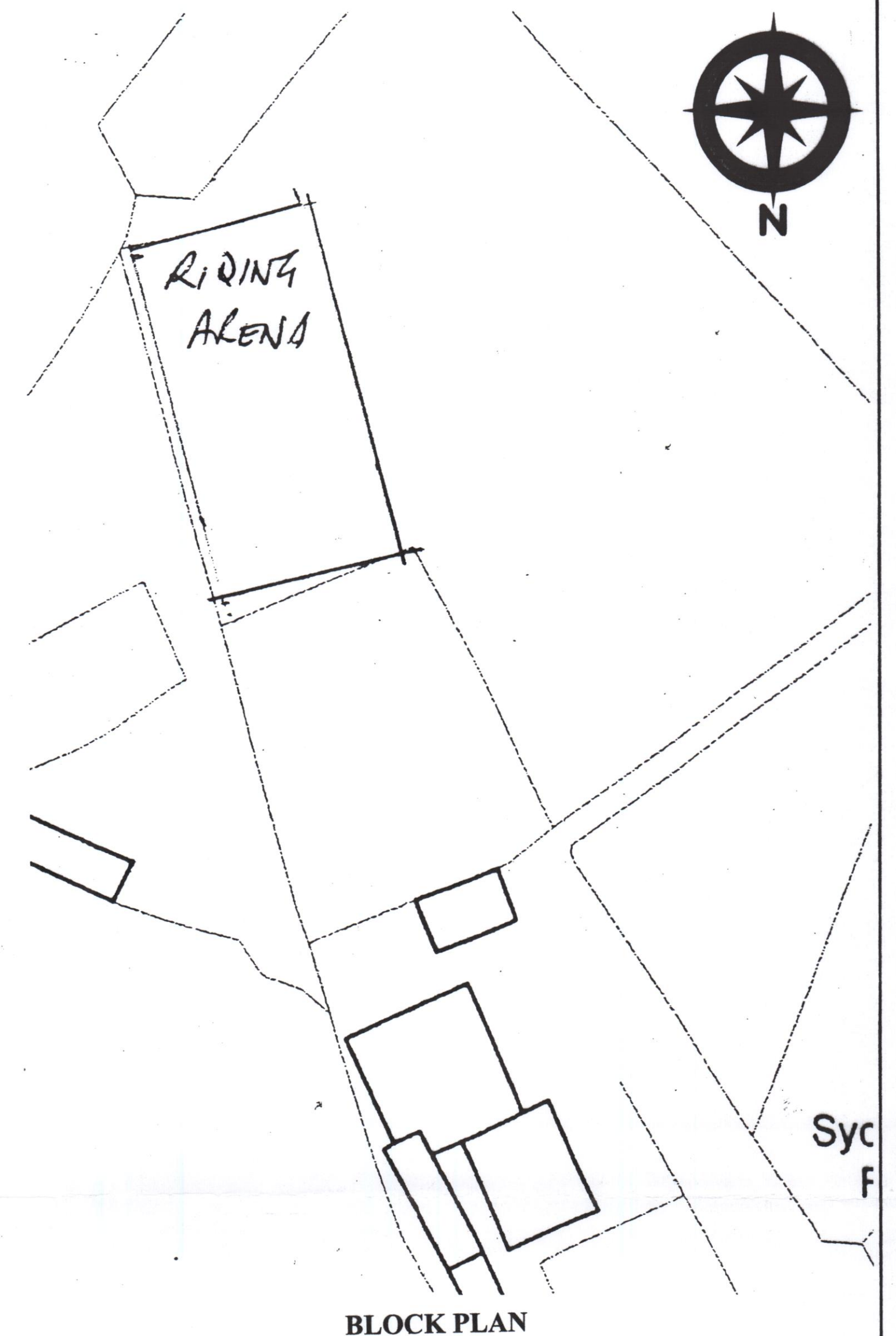

BLOCK PLAN

## MISS. J. BETTANY

DATE June 15

### PROPOSED RELOCATION OF MENAGE

AT  
SYCAMORE FARM,  
THE HOLLOW,  
CAVERSWALL,  
STOKE-ON-TRENT,  
STAFFS. ST11 9EE

#### SCALES:

PLAN	1:100
ELEVATIONS	1:100
BLOCK PLAN	1:500
LOCATION PLAN	1:1250

DRAWN BY  
**MALCOLM SALES**  
QUANTITY SURVEYORS, DESIGNERS  
& BUILDING COST CONSULTANTS  
CHURCHILL SUITE,  
LULWORTH HOUSE,  
51, HIGH STREET,  
CHEADLE, STOKE-ON-TRENT,  
STAFFS. ST10 1AR  
TEL: 01538 757233  
MOB: 07889 225437  
E-MAIL Malcolm.Sales@salesqs.co.uk

AS PROPOSED

FOR PLANNING APPLICATION

DRAWING NR. 1505/05/01